



OWNER'S MANUAL

Kino

125

YJ125S

LIT-11626-17-43

5YR-F8199-10

EAU10041

 **WARNING**

The engine exhaust from this product contains chemicals known to the State of California to cause cancer, birth defects or other reproductive harm.

YAMAHA

LIT-CALIF-65-01

Congratulations on your purchase of the Yamaha VINO125. This model is the result of Yamaha's vast experience in the production of fine sporting, touring, and pacesetting racing machines. It represents the high degree of craftsmanship and reliability that have made Yamaha a leader in these fields.

EAU10090

This manual will give you an understanding of the operation, inspection, and basic maintenance of this scooter. If you have any questions concerning the operation or maintenance of your scooter, please consult a Yamaha dealer.

The design and manufacture of this Yamaha scooter fully comply with the emissions standards for clean air applicable at the date of manufacture. Yamaha has met these standards without reducing the performance or economy of operation of the scooter. To maintain these high standards, it is important that you and your Yamaha dealer pay close attention to the recommended maintenance schedules and operating instructions contained within this manual.

IMPORTANT MANUAL INFORMATION

Particularly important information is distinguished in this manual by the following notations:



The Safety Alert Symbol means **ATTENTION! BECOME ALERT! YOUR SAFETY IS INVOLVED!**

! WARNING

Failure to follow **WARNING** instructions could result in severe injury or death to the scooter operator, a bystander, or a person inspecting or repairing the scooter.

CAUTION:

A **CAUTION** indicates special precautions that must be taken to avoid damage to the scooter.

NOTE:

A **NOTE** provides key information to make procedures easier or clearer.

NOTE:

- This manual should be considered a permanent part of this scooter and should remain with it even if the scooter is subsequently sold.
- Yamaha continually seeks advancements in product design and quality. Therefore, while this manual contains the most current product information available at the time of printing, there may be minor discrepancies between your scooter and this manual. If you have any questions concerning this manual, please consult your Yamaha dealer.

! WARNING

PLEASE READ THIS MANUAL CAREFULLY AND COMPLETELY BEFORE OPERATING THIS SCOOTER.

AFFIX DEALER
LABEL HERE

**VINO125
OWNER'S MANUAL
©2003 by Yamaha Motor Taiwan Co., Ltd.
1st edition, November 2003
All rights reserved.
Any reprinting or unauthorized use
without the written permission of
Yamaha Motor Taiwan Co., Ltd.
is expressly prohibited.
Printed in Taiwan.
P/N LIT-11626-17-43**

TABLE OF CONTENTS

SAFETY INFORMATION	1-1	Ignition circuit cut-off system	3-9	Replacing the tail/brake light bulb	6-11
Further safe-riding points	1-5	PRE-OPERATION CHECKS	4-1	Replacing a turn signal light bulb	6-11
Location of important labels	1-6	Pre-operation check list	4-2	OPERATION AND IMPORTANT RIDING POINTS	5-1
DESCRIPTION	2-1	Starting a cold engine	5-1	Checking the front brake pads and rear brake shoes	6-12
Left view	2-1	Starting off	5-2	Checking the brake fluid level	6-13
Right view	2-2	Acceleration and deceleration	5-2	Changing the brake fluid	6-13
Controls and instruments	2-3	Braking	5-3	Checking and lubricating the cables	6-14
INSTRUMENT AND CONTROL FUNCTIONS	3-1	Engine break-in	5-3	Checking and lubricating the throttle grip and cable	6-14
Main switch/steering lock	3-1	Parking	5-4	Lubricating the front and rear brake levers	6-14
Indicator lights	3-2	PERIODIC MAINTENANCE AND MINOR REPAIR	6-1	Checking and lubricating the centerstand and sidestand	6-15
Handlebar switches	3-2	PERIODIC MAINTENANCE	6-1	Checking the front fork	6-15
Speedometer unit	3-3	Owner's tool kit	6-1	Checking the steering	6-16
Fuel gauge	3-3	Periodic maintenance chart for the emission control system	6-2	Replacing the headlight bulb	6-16
Front brake lever	3-3	General maintenance and lubrication chart	6-3	Final transmission oil	6-17
Rear brake lever	3-4	Removing and installing panels	6-6	Adjusting the carburetor	6-19
Fuel tank cap	3-4	Checking the spark plug	6-7	Adjusting the throttle cable free play	6-19
Fuel	3-5	Air filter and V-belt case air filter elements	6-8		
Catalytic converter	3-5				
Kickstarter	3-6				
Seat	3-6				
Helmet holder	3-6				
Storage compartment	3-7				
Luggage hook	3-8				
Carrier	3-8				
Sidestand	3-8				

TABLE OF CONTENTS

Tires	6-19
Cast wheels	6-21
Adjusting the brake lever free play	6-21
Adjusting the rear brake lever free play	6-21
Battery	6-22
Replacing the fuse	6-23
Engine oil and oil strainer	6-24
Troubleshooting	6-26
Troubleshooting chart	6-27
SCOOTER CARE AND STOR- AGE	7-1
Care	7-1
Storage	7-3
SPECIFICATIONS	8-1
CONSUMER INFORMATION	9-1
Identification numbers	9-1
Reporting safety defects	9-3
Motorcycle noise regulation ..	9-4
YAMAHA MOTOR CORPORA- TION, U.S.A STREET AND ENDURO MOTORCYCLE LIMITED WARRANTY	9-5
YAMAHA EXTENDED SER- VICE (Y.E.S.)	9-7

SAFETY INFORMATION

1

EAU10260

SCOOTERS ARE SINGLE TRACK VEHICLES. THEIR SAFE USE AND OPERATION ARE DEPENDENT UPON THE USE OF PROPER RIDING TECHNIQUES AS WELL AS THE EXPERIENCE OF THE OPERATOR. EVERY OPERATOR SHOULD KNOW THE FOLLOWING REQUIREMENTS BEFORE RIDING THIS SCOOTER.

HE OR SHE SHOULD:

- OBTAIN THOROUGH INSTRUCTIONS FROM A COMPETENT SOURCE ON ALL ASPECTS OF SCOOTER OPERATION.
- OBSERVE THE WARNINGS AND MAINTENANCE REQUIREMENTS IN THE OWNER'S MANUAL.
- OBTAIN QUALIFIED TRAINING IN SAFE AND PROPER RIDING TECHNIQUES.
- OBTAIN PROFESSIONAL TECHNICAL SERVICE AS INDICATED BY THE OWNER'S MANUAL AND/OR WHEN MADE NECESSARY BY MECHANICAL CONDITIONS.

Safe riding

- Always make pre-operation checks. Careful checks may help prevent an accident.
- This scooter is designed to carry the operator and passenger.
- The failure of motorists to detect and recognize scooters in traffic is the predominating cause of automobile/scooter accidents. Many accidents have been caused by an automobile driver who did not see the scooter. Making yourself conspicuous appears to be very effective in reducing the chance of this type of accident.

Therefore:

- Wear a brightly colored jacket.
- Use extra caution when approaching and passing through intersections, since intersections are the most likely places for scooter accidents to occur.
- Ride where other motorists can see you. Avoid riding in another motorist's blind spot.

- Many accidents involve inexperienced operators. In fact, many operators who have been involved in accidents do not even have a current driver's license.
- Make sure that you are qualified and that you only lend your scooter to other qualified operators.
- Know your skills and limits. Staying within your limits may help you to avoid an accident.
- We recommend that you practice riding your scooter where there is no traffic until you have become thoroughly familiar with the scooter and all of its controls.

Many accidents have been caused by error of the scooter operator. A typical error made by the operator is veering wide on a turn due to **EXCESSIVE SPEED** or undercornering (insufficient lean angle for the speed).

- Always obey the speed limit and never travel faster than warranted by road and traffic conditions.

- Always signal before turning or changing lanes. Make sure that other motorists can see you.
- The posture of the operator and passenger is important for proper control.
- The operator should keep both hands on the handlebar and both feet on the footboard during operation to maintain control of the scooter.
- The passenger should always hold onto the operator, the seat strap or grab bar, if equipped, with both hands and keep both feet on the passenger foot-rests.
- Never carry a passenger unless he or she can firmly place both feet on the passenger foot-rests.
- Never ride under the influence of alcohol or other drugs. This scooter is designed for on-road use only. It is not suitable for off-road use.

Protective apparel

The majority of fatalities from scooter accidents are the result of head injuries. The use of a safety helmet is the single most critical factor in the prevention or reduction of head injuries.

- Always wear an approved helmet.
- Wear a face shield or goggles. Wind in your unprotected eyes could contribute to an impairment of vision which could delay seeing a hazard.
- The use of a jacket, substantial shoes, trousers, gloves, etc., is effective in preventing or reducing abrasions or lacerations.
- Never wear loose-fitting clothes, otherwise they could catch on the control levers or wheels and cause injury or an accident.
- Never touch the engine or exhaust system during or after operation. They become very hot and can cause burns. Always wear protective clothing that covers your legs, ankles, and feet.
- Passengers should also observe the above precautions.

Modifications

Modifications made to this scooter not approved by Yamaha, or the removal of original equipment, may render the scooter unsafe for use and may cause severe personal injury. Modifications may also make your scooter illegal to use.

Loading and accessories

Adding accessories or cargo to your scooter can adversely affect stability and handling if the weight distribution of the scooter is changed. To avoid the possibility of an accident, use extreme caution when adding cargo or accessories to your scooter. Use extra care when riding a scooter that has added cargo or accessories. Here are some general guidelines to follow if loading cargo or adding accessories to your scooter:

SAFETY INFORMATION

Loading

The total weight of the operator, passenger, accessories and cargo must not exceed the maximum load limit of 144 kg (317 lb). When loading within this weight limit, keep the following in mind:

- Cargo and accessory weight should be kept as low and close to the scooter as possible. Make sure to distribute the weight as evenly as possible on both sides of the scooter to minimize imbalance or instability.
- Shifting weights can create a sudden imbalance. Make sure that accessories and cargo are securely attached to the scooter before riding. Check accessory mounts and cargo restraints frequently.
- Never attach any large or heavy items to the handlebar, front fork, or front fender. Such items can create unstable handling or a slow steering response.

Accessories

Genuine Yamaha accessories have been specifically designed for use on this scooter. Since Yamaha cannot test all other accessories that may be available, you must personally be responsible for the proper selection, installation and use of non-Yamaha accessories. Use extreme caution when selecting and installing any accessories.

Keep the following guidelines in mind, as well as those provided under “Loading” when mounting accessories.

- Never install accessories or carry cargo that would impair the performance of your scooter. Carefully inspect the accessory before using it to make sure that it does not in any way reduce ground clearance or cornering clearance, limit suspension travel, steering travel or control operation, or obscure lights or reflectors.
- Accessories fitted to the handlebar or the front fork area can create instability due to improper weight distribution or aerodynamic changes. If

accessories are added to the handlebar or front fork area, they must be as lightweight as possible and should be kept to a minimum.

- Bulky or large accessories may seriously affect the stability of the scooter due to aerodynamic effects. Wind may attempt to lift the scooter, or the scooter may become unstable in cross winds. These accessories may also cause instability when passing or being passed by large vehicles.
- Certain accessories can displace the operator from his or her normal riding position. This improper position limits the freedom of movement of the operator and may limit control ability, therefore, such accessories are not recommended.
- Use caution when adding electrical accessories. If electrical accessories exceed the capacity of the scooter’s electrical system an elec-

tric failure could result, which could cause a dangerous loss of lights or engine power.

Gasoline and exhaust gas

- **GASOLINE IS HIGHLY FLAMMABLE:**
 - Always turn the engine off when refueling.
 - Take care not to spill any gasoline on the engine or exhaust system when refueling.
 - Never refuel while smoking or in the vicinity of an open flame.
- Never start the engine or let it run for any length of time in a closed area. The exhaust fumes are poisonous and may cause loss of consciousness and death within a short time. Always operate your scooter in an area that has adequate ventilation.
- Always turn the engine off before leaving the scooter unattended and remove the key from the main switch. When parking the scooter, note the following:

- The engine and exhaust system may be hot, therefore, park the scooter in a place where pedestrians or children are not likely to touch these hot areas.
- Do not park the scooter on a slope or soft ground, otherwise it may fall over.
- Do not park the scooter near a flammable source (e.g., a kerosene heater, or near an open flame), otherwise it could catch fire.
- If you should swallow any gasoline, inhale a lot of gasoline vapor, or allow gasoline to get into your eyes, see your doctor immediately. If any gasoline spills on your skin or clothing, immediately wash the affected area with soap and water and change your clothes.

SAFETY INFORMATION

EAU10350

Further safe-riding points

1



ZALM00**

Turn left

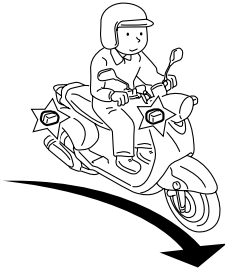

ZALM00**

Turn right

- Make sure to signal clearly when making turns.

- Braking can be extremely difficult on a wet road. Avoid hard braking, because the scooter could slide. Apply the brakes slowly when stopping on a wet surface.
- Slow down as you approach a corner or turn. Once you have completed a turn, accelerate slowly.
- Be careful when passing parked cars. A driver might not see you and open a door in your path.
- Railroad crossings, streetcar rails, iron plates on road construction sites, and manhole covers become extremely slippery when wet. Slow down and cross them with caution. Keep the scooter upright, otherwise it could slide out from under you.
- The brake lining could get wet when you wash the scooter. After washing the scooter, check the brakes before riding.
- Always wear a helmet, gloves, trousers (tapered around the cuff and ankle so they do not flap), and a bright colored jacket.
- Do not carry too much luggage on the scooter. An overloaded scooter

is unstable. Use a strong cord to secure any luggage to the carriers. A loose load will affect the stability of the scooter and could divert your attention from the road. (See page 1-2.)

Location of important labels

Please read the following important labels carefully before operating this vehicle.

1

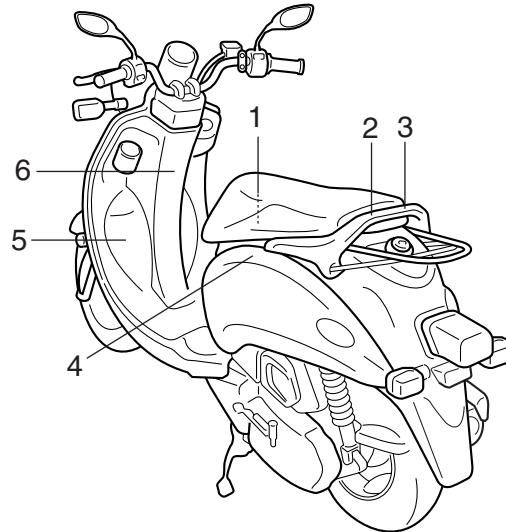

SAFETY INFORMATION

1

1



2



3



4



5



6

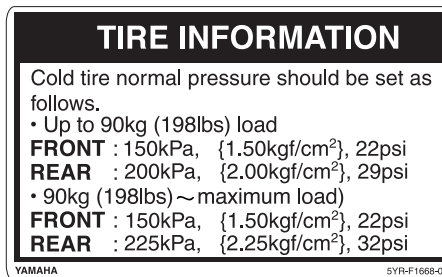

Left view

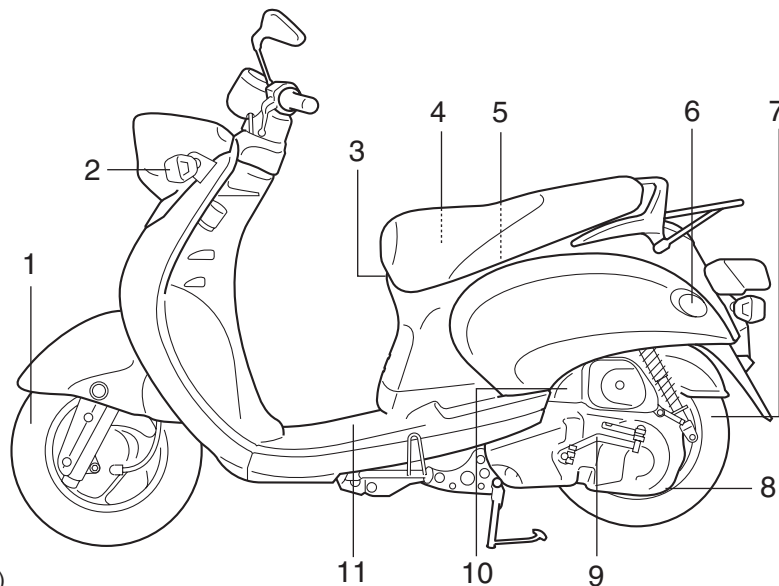

1. Front wheel (page 6-19)
2. Front turn signal light (page 3-2)
3. Luggage hook (page 3-8)
4. Helmet holder (page 3-6)
5. Storage compartment (page 3-7)
6. Rear turn signal light (page 3-2)
7. Rear wheel (page 6-19)
8. Rear brake lever free play adjusting nut (page 6-21)
9. Kickstarter (page 3-6)
10. Air filter element (page 6-8)
11. Battery (page 6-22)

DESCRIPTION

EAU10420

Right view

2

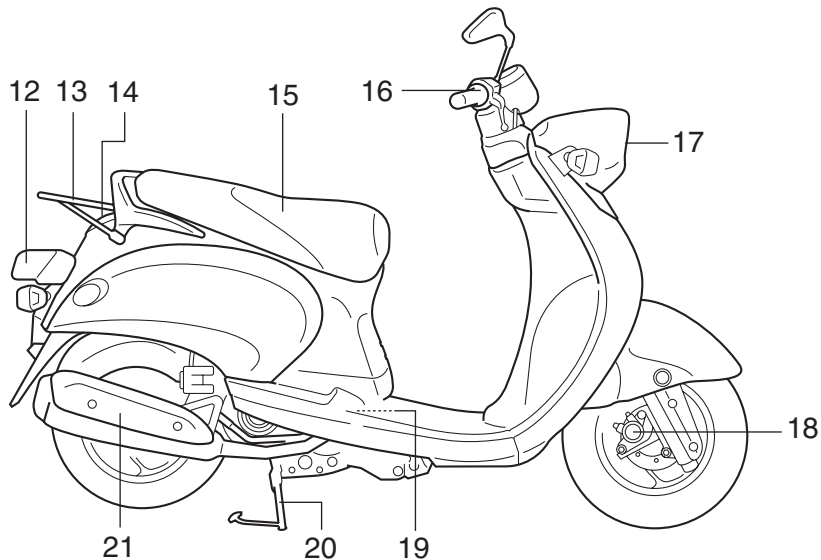

- 12.Tail/brake light (page6-11)
- 13.Carrier (page3-8)
- 14.Fuel tank cap (page 3-4)
- 15.Seat (page 3-6)
- 16.Brake master cylinder (page 6-13)
- 17.Headlight (page 6-16)
- 18.Front brake caliper (page 6-12)
- 19.Spark plug (page 6-7)
- 20.Centerstand (page 6-15)
- 21.Muffler (page 3-5)

Controls and instruments

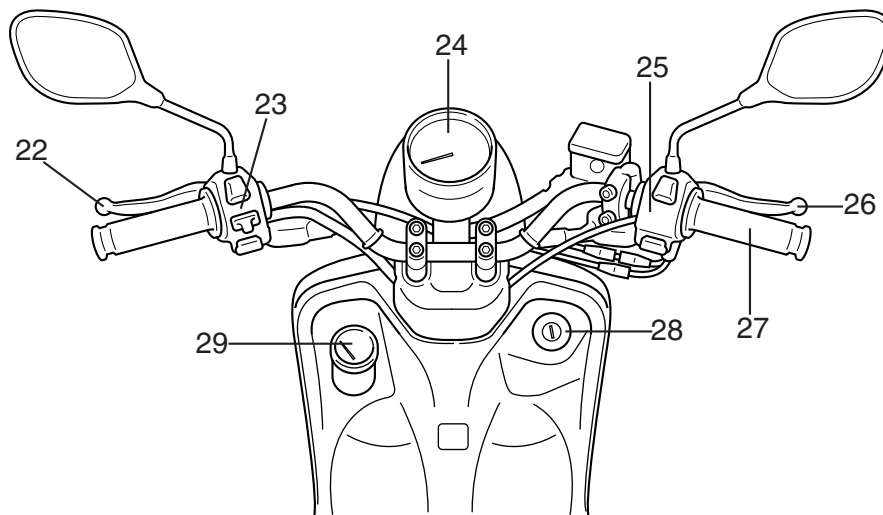

- 22.Rear brake lever (page 3-4)
- 23.Left handlebar switches (page 3-2)
- 24.Speedometer unit (page 3-3)
- 25.Right handlebar switches (page 3-2)
- 26.Front brake lever (page 3-3)
- 27.Throttle grip (page 6-19)
- 28.Main switch / steering lock (page 3-1)
- 29.Fuel gauge (page 3-3)

INSTRUMENT AND CONTROL FUNCTIONS

EAU10460

Main switch/steering lock

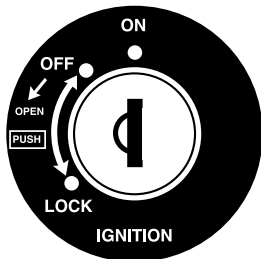

3

ZALUM00''

The main switch/steering lock controls the ignition and lighting systems, and is used to lock the steering. The various positions are described below.

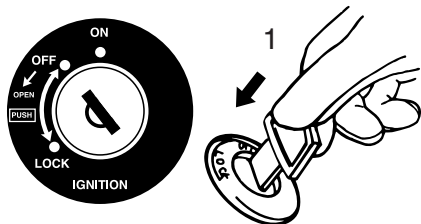

ZALUM00''

1. Push

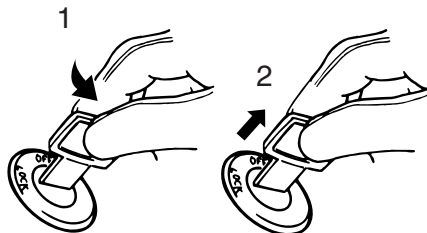

ZALUM00''

1. Turn
2. Release

EAU10530

ON

All electrical circuits are supplied with power, the taillight comes on, and the engine can be started. The key cannot be removed.

NOTE:

The headlight and meter lighting come on automatically when the engine is started.

EAU10660

OFF

All electrical systems are off. The key can be removed.

EAU10680

LOCK

The steering is locked, and all electrical systems are off. The key can be removed.

To lock the steering

1. Turn the handlebars all the way to the left.
2. Push the key in from the "OFF" position, and then turn it to "LOCK" while still pushing it.
3. Remove the key.

To unlock the steering

Push the key in, and then turn it to "OFF" while still pushing it.

EWA10060

WARNING

Never turn the key to "OFF" or "LOCK" while the vehicle is moving, otherwise the electrical systems will be switched off, which may result in loss of control or an accident. Make sure that the vehicle is stopped before turning the key to "OFF" or "LOCK".

Indicator lights

EAU10980

Turn signal indicator light “↔”

EAU11020

This indicator light flashes when the turn signal switch is pushed to the left or right.

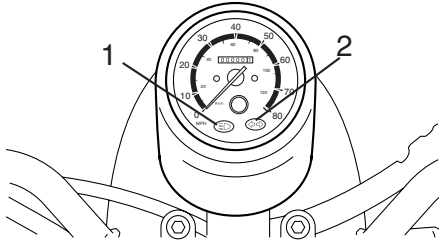

ZALUM00**

1. High beam indicator light “≡D”
2. Turn indicator light “↔”

High beam indicator light “≡D”

EAU11080

This indicator light comes on when the high beam of the headlight is switched on.

Handlebar switches

EAU12342

Dimmer switch “≡D≡D”

EAU12400

Set this switch to “≡D” for the high beam and to “≡D” for the low beam.

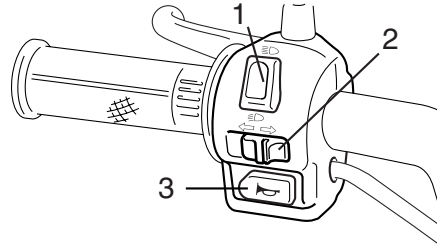

ZALUM00**

1. Dimmer switch “≡D≡D”
2. Turn signal switch “↔↔”
3. Horn switch “♫”

Turn signal switch “↔↔”

EAU12460

To signal a right-hand turn, push this switch to “↔”. To signal a left-hand turn, push this switch to “↔”. When released, the switch returns to the center position. To cancel the turn signal lights, push the switch in after it has returned to the center position.

Horn switch “♫”

EAU12500

Press this switch to sound the horn.

Engine stop switch “⊗/⊗”

EAU12660

Set this switch to “⊗” before starting the engine. Set this switch to “⊗” to stop the engine in case of an emergency, such as when the motorcycle overturns or when the throttle cable is stuck.

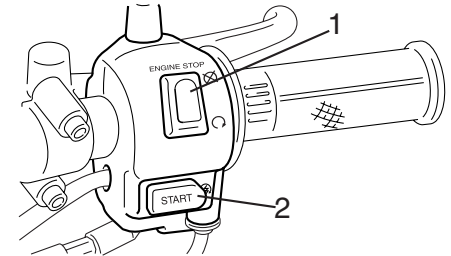

ZALUM00**

1. Engine stop switch “⊗/⊗”
2. Start switch “⊗”

Start switch “⊗”

EAU12700

Push this switch while applying the front or rear brake to crank the engine with the starter.

CAUTION:

See page 5-1 for starting instructions prior to starting the engine.

ECA10050

INSTRUMENT AND CONTROL FUNCTIONS

Speedometer unit

EAU11620

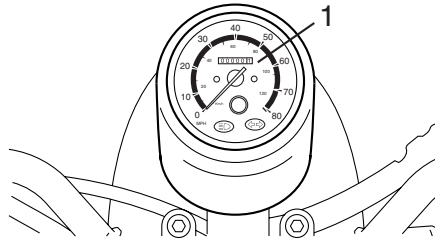

ZALM00**

1. Speedometer

The speedometer unit is equipped with a speedometer and an odometer. The speedometer shows riding speed. The odometer shows the total distance traveled.

Fuel gauge

EAU12150

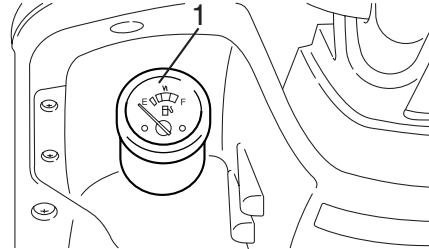

ZALM00**

1. Fuel gauge

The fuel gauge indicates the amount of fuel in the fuel tank. The needle moves towards "E" (Empty) as the fuel level decreases. When the needle reaches the red line, refuel as soon as possible.

NOTE: _____
Do not allow the fuel tank to empty itself completely.

Front brake lever

EAU12900

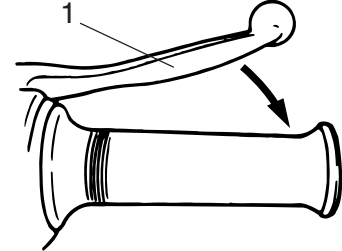

ZALM00**

1. Front brake lever

The front brake lever is located on the right handlebar grip. To apply the front brake, pull this lever toward the handlebar grip.

Rear brake lever

EAU12950

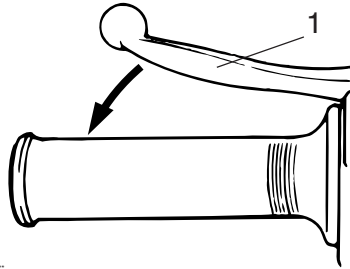

ZALIM00**

1. Rear brake lever

The rear brake lever is located on the left handlebar grip. To apply the rear brake, pull this lever toward the handlebar grip.

Recommended fuel:
REGULAR UNLEADED GASO-
LINE ONLY
Fuel tank capacity:
4.5 L (1.18 US gal) (0.98 Imp.gal)

Your Yamaha engine has been designed to use regular unleaded gasoline with a pump octane number $[(R+M)/2]$ of 86 or higher, or a research octane number of 91 or higher. If knocking (or pinging) occurs, use a gasoline of a different brand or a gasoline or premium unleaded fuel. Use of unleaded fuel will extend spark plug life and reduce maintenance cost.

Gasohol

There are two types of gasohol: gasohol containing ethanol and that containing methanol. Gasohol containing ethanol can be used if ethanol content does not exceed 10%. Gasohol containing methanol is not recommended by Yamaha because it can cause damage to the fuel system or vehicle performance problems.

EAU32430

Fuel tank cap

EAU32481

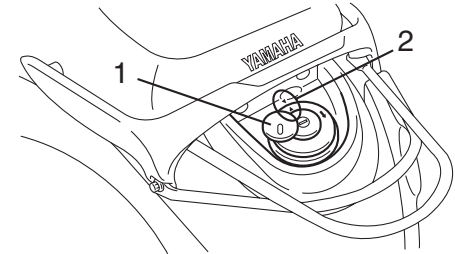

ZALIM00**

1. Fuel tank cap cover
2. Match mark

To remove the fuel tank cap

Slide the lock cover open, insert the key into the lock, and then turn it 1/4 turn clockwise. The lock will be released and the fuel tank cap can be removed.

To install the fuel tank cap

1. Insert the fuel tank cap into the tank opening with the key inserted in the lock and with the marks on the cap and tank aligned.
2. Turn the key counterclockwise to the original position, remove it, and then close the lock cover.

INSTRUMENT AND CONTROL FUNCTIONS

NOTE:

The fuel tank cap cannot be installed unless the key is in the lock. In addition, the key cannot be removed if the cap is not properly installed and locked.

EWA10130

⚠ WARNING

Make sure that the fuel tank cap is properly installed before riding.

EAU13210

Fuel

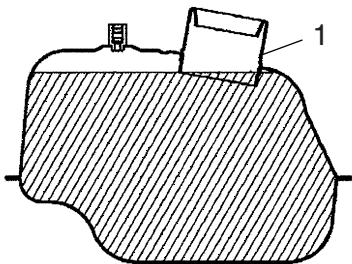

ZALM00**

1. Fuel tank filler tube

Make sure that there is sufficient fuel in the tank. Fill the fuel tank to the bottom of the filler tube as shown.

EWA10880

⚠ WARNING

- Do not overfill the fuel tank, otherwise it may overflow when the fuel warms up and expands.
- Avoid spilling fuel on the hot engine.

ECA10070

CAUTION:

Immediately wipe off spilled fuel with a clean, dry, soft cloth, since fuel may deteriorate painted surfaces or plastic parts.

EAU13440

Catalytic converter

This vehicle is equipped with a catalytic converter in the muffler.

EWA10860

⚠ WARNING

The exhaust system is hot after operation. Make sure that the exhaust system has cooled down before doing any maintenance work.

ECA10700

CAUTION:

The following precautions must be observed to prevent a fire hazard or other damages.

- Use only unleaded gasoline. The use of leaded gasoline will cause unreparable damage to the catalytic converter.
- Never park the vehicle near possible fire hazards such as grass or other materials that easily burn.
- Do not allow the engine to idle too long.

Kickstarter

EAU13680

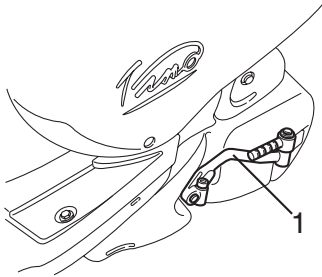

ZALM00**

1. Kickstarter

To start the engine, fold out the kickstarter lever, move it down lightly with your foot until the gears engage, and then push it down smoothly but forcefully.

Seat

EAU13931

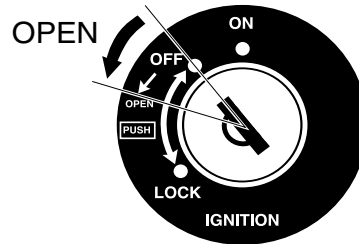

ZALM00**

To open the seat

1. Place the scooter on the centerstand.
2. Insert the key into the main switch, and then turn it counterclockwise.

NOTE: _____
Do not push inward when turning the key.

3. Fold the seat up.

To close the seat

1. Fold the seat down, and then push it down to lock it in place.
2. Remove the key from the main switch if the scooter will be left unattended.

NOTE: _____
Make sure that the seat is properly secured before riding.

Helmet holder

EAU14300

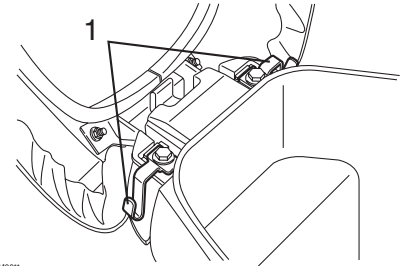

ZALM00**

1. Helmet holder (x2)

The helmet holder is located under the seat.

To secure a helmet to the helmet holder

1. Open the seat. (See page 3-6.)
2. Attach the helmet to the helmet holder, and then securely close the seat.

INSTRUMENT AND CONTROL FUNCTIONS

EWA10160

⚠ WARNING

Never ride with a helmet attached to the helmet holder, since the helmet may hit objects, causing loss of control and possibly an accident.

3 To release the helmet from the helmet holder

Open the seat, remove the helmet from the helmet holder, and then close the seat.

Storage compartment

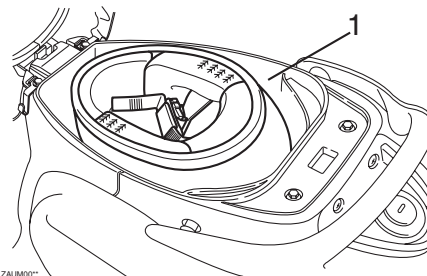

EAU14510

1. Storage compartment

There is a storage compartment under the seat. (See page 3-6.)

EWA10960

⚠ WARNING

- Do not exceed the load limit of 5 kg (11 lb) for the storage compartment.
- Do not exceed the maximum load of 144 kg (317 lb) for the vehicle.

ECA10080

CAUTION:

Keep the following points in mind when using the storage compartment.

- Since the storage compartment accumulates heat when exposed to the sun, do not store anything susceptible to heat inside it.
- To avoid humidity from spreading through the storage compartment, wrap wet articles in a plastic bag before storing them in the compartment.
- Since the storage compartment may get wet while the scooter is being washed, wrap any articles stored in the compartment in a plastic bag.
- Do not keep anything valuable or breakable in the storage compartment.

To store a helmet in the storage compartment, place the helmet upside-down with the front facing forward.

NOTE:

- Some helmets cannot be stored in the storage compartment because of their size or shape.
- Do not leave your scooter untended with the seat open.

Luggage hook

EAUT1070

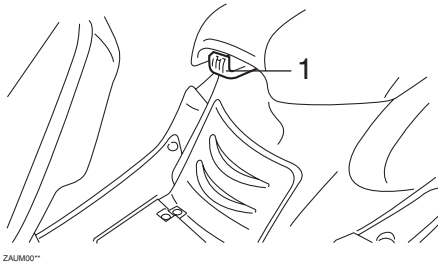

1. Luggage hook

EWA1030

⚠ WARNING

- Do not exceed the load limit of 3 kg (7 lb) for the luggage hook.
- Do not exceed the maximum load of 144 kg (317 lb) for the vehicle.

Carrier

EAU15110

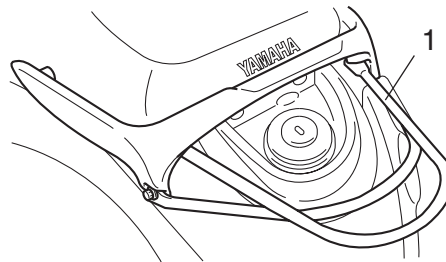

ZALM00**

1. rear carrier

EWA10170

⚠ WARNING

- Do not exceed the load limit of 3 kg (7 lb) for the carrier.
- Do not exceed the maximum load of 144 kg (317 lb) for the vehicle.

EAU15300

Sidestand

The sidestand is located on the left side of the frame. Raise the sidestand or lower it with your foot while holding the motorcycle upright.

NOTE:

The built-in sidestand switch is part of the ignition circuit cut-off system, which cuts the ignition in certain situations. (See further down for an explanation of the ignition circuit cut-off system.)

3

EWA10240

⚠ WARNING

The vehicle must not be ridden with the sidestand down, or if the sidestand cannot be properly moved up (or does not stay up), otherwise the sidestand could contact the ground and distract the operator, resulting in a possible loss of control. Yamaha's ignition circuit cut-off system has been designed to assist the operator in fulfilling the responsibility of raising the sidestand before starting off. Therefore, check this sys-

INSTRUMENT AND CONTROL FUNCTIONS

tem regularly as described below and have a Yamaha dealer repair it if it does not function properly.

EAU15371

Ignition circuit cut-off system

The ignition circuit cut-off system (comprising the sidestand switch and brake light switches) has the following functions.

- It prevents starting when the sidestand is up, but neither brake is applied.
- It prevents starting when either brake is applied, but the sidestand is still down.
- It cuts the running engine when the sidestand is moved down.

Periodically check the operation of the ignition circuit cut-off system according to the following procedure.

EWA10250

⚠ WARNING

If a malfunction is noted, have a Yamaha dealer check the system before riding.

INSTRUMENT AND CONTROL FUNCTIONS

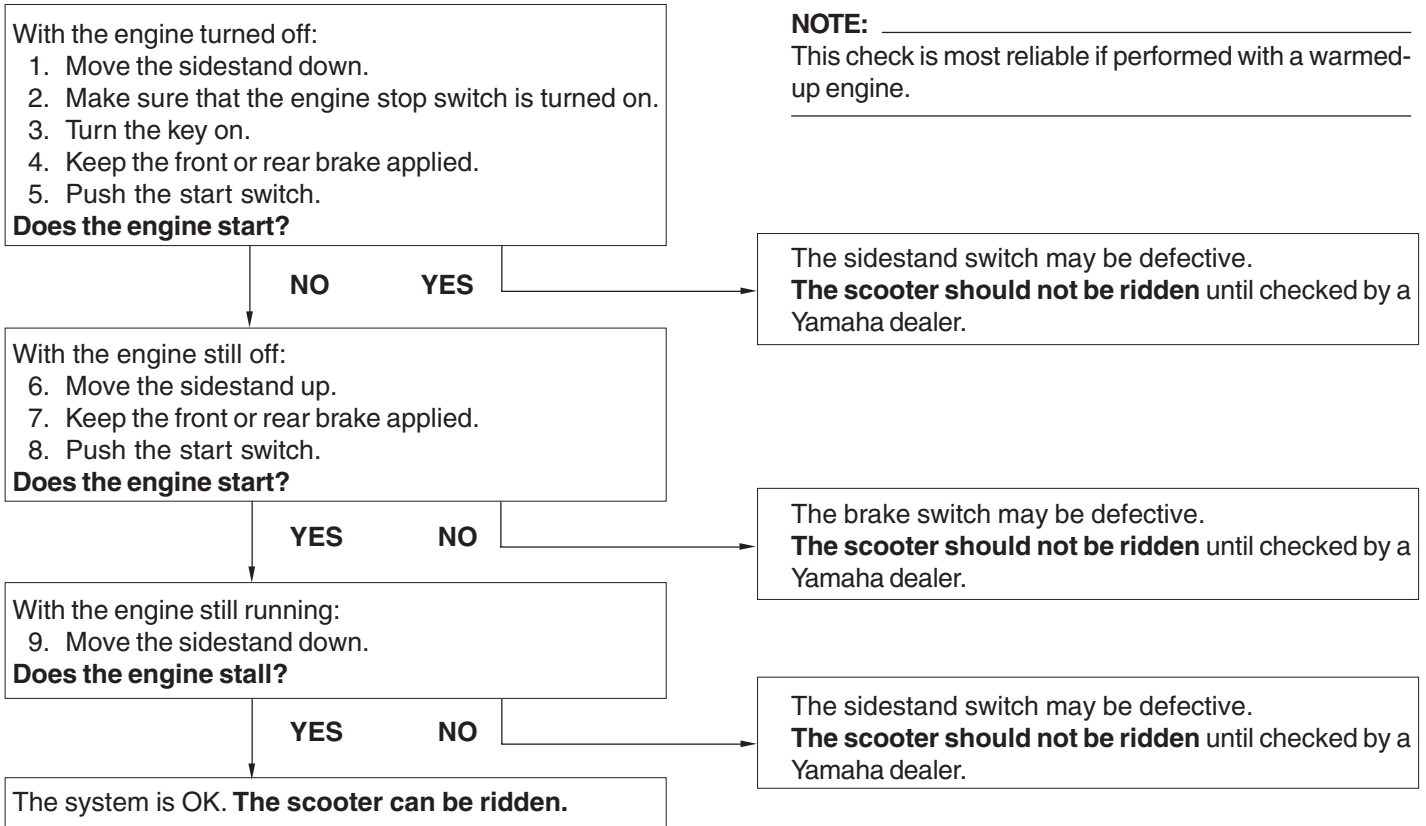

PRE-OPERATION CHECKS

EUA15591

The condition of a vehicle is the owner's responsibility. Vital components can start to deteriorate quickly and unexpectedly, even if the vehicle remains unused (for example, as a result of exposure to the elements). Any damage, fluid leakage or loss of tire air pressure could have serious consequences. Therefore, it is very important, in addition to a thorough visual inspection, to check the following points before each ride.

NOTE:

Pre-operation checks should be made each time the vehicle is used. Such an inspection can be accomplished in a very short time; and the added safety it assures is more than worth the time involved.

EWA11150

⚠ WARNING

If any item in the Pre-operation check list is not working properly, have it inspected and repaired before operating the vehicle.

Pre-operation check list

ITEM	CHECKS	PAGE
Fuel	<ul style="list-style-type: none"> • Check fuel level in fuel tank. • Refuel if necessary. • Check fuel line for leakage. 	3-2, 3-5
Engine oil	<ul style="list-style-type: none"> • Check oil level in engine. • If necessary, add recommended oil to specified level. • Check vehicle for oil leakage. 	6-24
Final transmission oil	<ul style="list-style-type: none"> • Check vehicle for oil leakage. 	6-17
Front brake	<ul style="list-style-type: none"> • Check operation. • If soft or spongy, have Yamaha dealer bleed hydraulic system. • Check fluid level in reservoir. • If necessary, add recommended brake fluid to specified level. • Check hydraulic system for leakage. • Check the brake pads for wear. 	6-12~6-13, 6-21
Rear brake	<ul style="list-style-type: none"> • Check operation. • Lubricate cable if necessary. • Check lever free play. • Adjust if necessary. 	6-21
Throttle grip	<ul style="list-style-type: none"> • Make sure that operation is smooth. • Check cable free play. • If necessary, have Yamaha dealer adjust cable free play and lubricate cable and grip housing. 	6-19
Wheels and tires	<ul style="list-style-type: none"> • Check for damage. • Check tire condition and tread depth. • Check air pressure. • Correct if necessary. 	6-19
Brake levers	<ul style="list-style-type: none"> • Make sure that operation is smooth. • Lubricate lever pivoting points if necessary. 	6-14
Centerstand, sidestand	<ul style="list-style-type: none"> • Make sure that operation is smooth. • Lubricate pivots if necessary. 	6-15

PRE-OPERATION CHECKS

ITEM	CHECKS	PAGE
Chassis fasteners	<ul style="list-style-type: none">• Make sure that all nuts, bolts and screws are properly tightened.• Tighten if necessary.	-
Instruments, lights, signals and switches	<ul style="list-style-type: none">• Check operation.• Correct if necessary.	3-2~3-3
Engine stop switch	<ul style="list-style-type: none">• Check operation.	3-2
Sidestand switch	<ul style="list-style-type: none">• Check operation of ignition circuit cut-off system.• If system is defective, have Yamaha dealer check vehicle.	3-8~3-10

OPERATION AND IMPORTANT RIDING POINTS

EAU15980
EWA10870

⚠ WARNING

- Become thoroughly familiar with all operating controls and their functions before riding. Consult a Yamaha dealer regarding any control or function that you do not thoroughly understand.
- Never start the engine or operate it in a closed area for any length of time. Exhaust fumes are poisonous, and inhaling them can cause loss of consciousness and death within a short time. Always make sure that there is adequate ventilation.
- For safety, always start the engine with the centerstand down.

Starting a cold engine

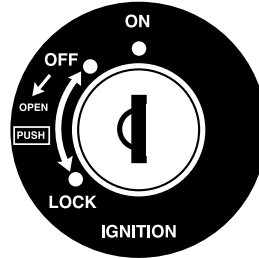

ZALM00*

EAU16590

- Never ride with the sidestand down.

1. Turn the key to "ON" and make sure that the engine stop switch is set to "O".
2. Close the throttle completely.
3. Start the engine by pushing the start switch while applying the front or rear brake.

ECA10250

⚠ CAUTION:

See page 5-3 for engine break-in instructions prior to operating the vehicle for the first time.

In order for the ignition circuit cut-off system to enable starting, the sidestand must be up.

EWA110290

⚠ WARNING

- Before starting the engine, check the function of the ignition circuit cut-off system according to the procedure described on page 3-8.

NOTE:

If the engine does not start, release the start switch, wait a few seconds, and then try again. Each starting attempt should be as short as possible to preserve the battery. Do not crank the engine more than 10 seconds on any one attempt. If the engine does not start, try with the throttle open 1/8 turn.

ECA11130

⚠ CAUTION:

For maximum engine life, always warm the engine up before starting off. Never accelerate hard when the engine is cold!

OPERATION AND IMPORTANT RIDING POINTS

EAU16770

EAU16780

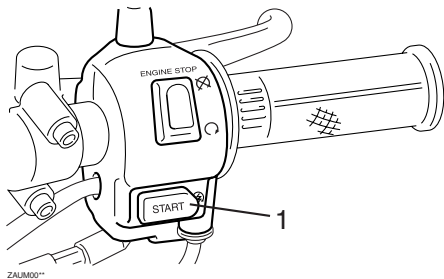

1. Start switch "Ⓝ"

Starting off



NOTE: _____
Before starting off, allow the engine to warm up.

1. While pulling the rear brake lever with your left hand and holding the carrier with your right hand, push the scooter off the centerstand.
2. Sit astride the seat, and then adjust the rear view mirrors.
3. Switch the turn signal on.
4. Check for oncoming traffic, and then slowly turn the throttle grip (on the right) in order to take off.
5. Switch the turn signal off.

Acceleration and deceleration

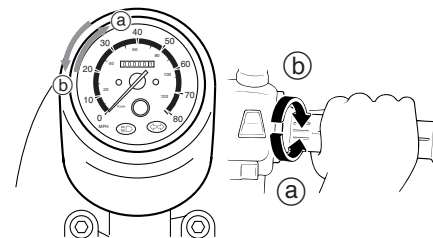

The speed can be adjusted by opening and closing the throttle. To increase the speed, turn the throttle grip in direction ⓐ. To reduce the speed, turn the throttle grip in direction ⓑ.

5

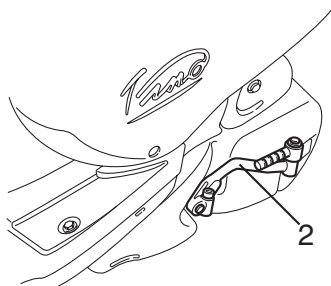

2. Kickstarter

Braking

EAU16791

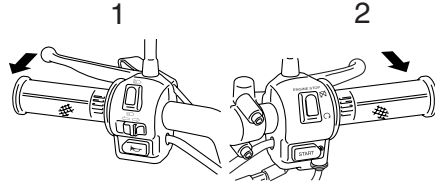

ZALM00**

1. Rear
2. Front

1. Close the throttle completely.
2. Apply both front and rear brakes simultaneously while gradually increasing the pressure.

EWA10300

⚠ WARNING

- **Avoid braking hard or suddenly (especially when leaning over to one side), otherwise the scooter may skid or overturn.**
- **Railroad crossings, streetcar rails, iron plates on road construction sites, and manhole covers become extremely slippery**

when wet. Therefore, slow down when approaching such areas and cross them with caution.

- **Keep in mind that braking on a wet road is much more difficult.**
- **Ride slowly down a hill, as braking downhill can be very difficult.**

EAU16830

Engine break-in

There is never a more important period in the life of your engine than the period between 0 and 1000 km (600 mi). For this reason, you should read the following material carefully.

Since the engine is brand new, do not put an excessive load on it for the first 1000 km (600 mi). The various parts in the engine wear and polish themselves to the correct operating clearances. During this period, prolonged full-throttle operation or any condition that might result in engine overheating must be avoided.

OPERATION AND IMPORTANT RIDING POINTS

0~500 km (0~300 mi)

EAU16990

Avoid prolonged operation above 1/3 throttle.

500~1000 km (300~600 mi)

Avoid prolonged operation above 1/2 throttle.

ECA11500

CAUTION:

After 1000 km (600 mi) of operation, the engine oil must be changed, and the oil filter element and the oil strainer cleaned.

1000 km (600 mi) and beyond

The vehicle can now be operated normally.

ECA10270

CAUTION:

If any engine trouble should occur during the engine break-in period, immediately have a Yamaha dealer check the vehicle.

Parking

EAU17211

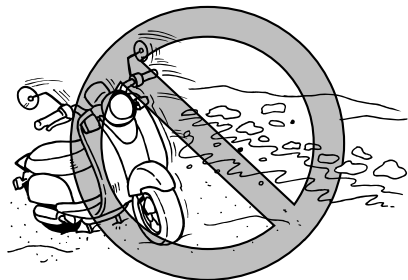
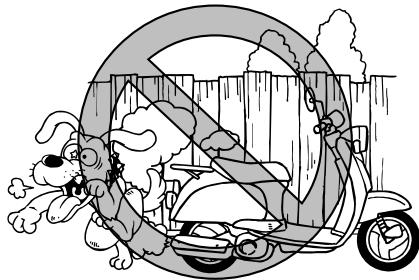

When parking, stop the engine, and then remove the key from the main switch.

EWA10310

WARNING

- Since the engine and exhaust system can become very hot, park in a place where pedestrians or children are not likely to touch them.
- Do not park on a slope or on soft ground, otherwise the vehicle may overturn.

ECA10380

CAUTION:

Never park in an area where there are fire hazards such as grass or other flammable materials.

EAU17231

Safety is an obligation of the owner. Periodic inspection, adjustment and lubrication will keep your vehicle in the safest and most efficient condition possible. The most important points of motorcycle inspection, adjustment, and lubrication are explained on the following pages.

Maintenance, replacement, or repair of the emission control devices and systems may be performed by any repair establishment or individual that is certified (if applicable).

EWA10320

⚠ WARNING

If you are not familiar with maintenance work, have a Yamaha dealer do it for you.

EAU17300

PERIODIC MAINTENANCE

PROPER PERIODIC MAINTENANCE OF YOUR MOTORCYCLE IS IMPORTANT IN ORDER TO ENJOY LONG, PLEASURABLE SERVICE. ESPECIALLY IMPORTANT ARE THE MAINTENANCE SERVICES RELATED TO EMISSIONS CONTROL. THESE CONTROLS NOT ONLY FUNCTION TO EN-

SURE CLEANER AIR, BUT ARE ALSO VITAL TO PROPER ENGINE OPERATION AND MAXIMUM PERFORMANCE. IN THE FOLLOWING PERIODIC MAINTENANCE CHARTS, THE SERVICES RELATED TO EMISSIONS CONTROL ARE GROUPED SEPARATELY. THESE SERVICES REQUIRE SPECIALIZED DATA, KNOWLEDGE, AND EQUIPMENT. YAMAHA DEALERS ARE TRAINED AND EQUIPPED TO PERFORM THESE PARTICULAR SERVICES.

EAU17370

Owner's tool kit

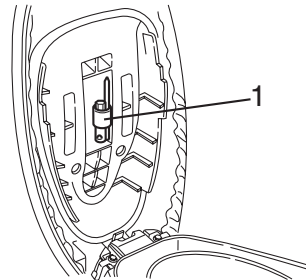

1. Owner's tool kit

The owner's tool kit is located under the seat. (See page 3-6.)

The service information included in this manual and the tools provided in the owner's tool kit are intended to assist you in the performance of preventive maintenance and minor repairs. However, additional tools such as a torque wrench may be necessary to perform certain maintenance work correctly.

NOTE:

If you do not have the tools or experience required for a particular job, have a Yamaha dealer perform it for you.

EWA10340

⚠ WARNING

Modifications not approved by Yamaha may cause loss of performance, excessive emissions, and render the vehicle unsafe for use. Consult a Yamaha dealer before attempting any changes.

PERIODIC MAINTENANCE AND MINOR REPAIR

EAU17560*

Periodic maintenance chart for the emission control system

NO.	ITEM	ROUTINE	ODOMETER READING				
			600 mi (1,000 km) or 1 month	2,000 mi (4,000 km) or 6 months	4,000 mi (7,000 km) or 12 months	6,000 mi (10,000 km) or 18 months	8,000 mi (13,000 km) or 24 months
1	* Fuel line	• Check fuel hoses and vacuum hose for cracks or damage.		√	√	√	√
2	* Valves	• Check valve clearance. • Adjust if necessary.		√	√	√	√
3	* Spark plug	• Check condition. • Clean and regap.		√	√	√	√
		• Replace.			√		√
4	* Air filter element	• Clean.		√		√	
		• Replace.			√		√
5	* Crankcase breather system	• Check breather hose for cracks or damage. • Replace if necessary.		√	√	√	√
6	* Carburetor	• Adjust engine idling speed.	√	√	√	√	√
7	* Exhaust system	• Check for leakage. • Tighten if necessary. • Replace gaskets if necessary.		√	√	√	√
8	* Evaporative emission control system	• Check control system for damage. • Replace if necessary.		√		√	
9	* Air induction system	• Check the air cut-off valve, reed valve, and hose for damage. • Replace any damaged.		√	√	√	√

* Since these items require special tools, data and technical skills, have a Yamaha dealer perform the service.

NOTE:

From 10000 mi (16000 km) or 30 months, repeat the maintenance intervals starting from 2000 mi (4000 km) or 6 months.

PERIODIC MAINTENANCE AND MINOR REPAIR

EAU32121

General maintenance and lubrication chart

NO.	ITEM	ROUTINE	ODOMETER READING				
			600 mi (1,000 km) or 1 month	2,000 mi (4,000 km) or 6 months	4,000 mi (7,000 km) or 12 months	6,000 mi (10,000 km) or 18 months	8,000 mi (13,000 km) or 24 months
1	*	V-belt case air filter elements	• Clean.	√		√	
			• Replace.		√		√
2	*	Front brake	• Check operation, fluid level and vehicle for fluid leakage. (See NOTE on page 6-5.)	√	√	√	√
			• Replace brake pads.	Whenever worn to the limit			
3	*	Rear brake	• Check operation and adjust brake lever free play.	√	√	√	√
			• Replace brake shoes.	Whenever worn to the limit			
4	*	Brake hose	• Check for cracks or damage.		√	√	√
			• Replace. (See NOTE on page 6-5.)	Every 4 years			
5	*	Wheels	• Check runout and for damage.		√	√	√
6	*	Tires	• Check tread depth and for damage.		√	√	√
			• Replace if necessary. • Check air pressure. • Correct if necessary.		√	√	√
7	*	Wheel bearings	• Check bearing for looseness or damage.		√	√	√
8	*	Steering bearings	• Check bearing play and steering for roughness.	√	√	√	√
			• Lubricate with lithium-soap-based grease.	Every 16,000 mi (24,000 km)			
9	*	Chassis fasteners	• Make sure that all nuts, bolts and screws are properly tightened.		√	√	√
10		Sidestand, centerstand	• Check operation. • Lubricate.		√	√	√

PERIODIC MAINTENANCE AND MINOR REPAIR

NO.	ITEM	ROUTINE	ODOMETER READING				
			600 mi (1,000 km) or 1 month	2,000 mi (4,000 km) or 6 months	4,000 mi (7,000 km) or 12 months	6,000 mi (10,000 km) or 18 months	8,000 mi (13,000 km) or 24 months
11	* Sidestand switch	• Check operation.	√	√	√	√	√
12	* Front fork	• Check operation and for oil leakage.		√	√	√	√
13	* Shock absorber assembly	• Check operation and shock absorber for oil leakage.		√	√	√	√
14	Engine oil	• Change. • Check oil level and vehicle for leakage.	√	Every 1,900 mi (3,000 km)			
15	* Engine oil filter element	• Clean.	√		√		√
16	* Engine oil strainer	• Clean.	√		√		√
17	Final transmission oil	• Change.	√		√		√
18	* V-belt	• Replace.	Every 12,000 mi (18,000 km)				
19	* Front and rear brake switches	• Check operation.	√	√	√	√	√
20	Moving parts and cables	• Lubricate.		√	√	√	√
21	* Throttle grip housing and cable	• Check operation and free play. • Adjust the throttle cable free play if necessary. • Lubricate the throttle grip housing and cable.		√	√	√	√
22	* Lights, signals and switches	• Check operation. • Adjust headlight beam.	√	√	√	√	√

* Since these items require special tools, data and technical skills, have a Yamaha dealer perform the service.

NOTE:

From 12000 mi (18000 km) or 36 months, repeat the maintenance intervals starting from 4000 mi (7000 km) or 12 months.

PERIODIC MAINTENANCE AND MINOR REPAIR

EAU17620

NOTE:

- The air filter needs more frequent service if you are riding in unusually wet or dusty areas.
 - Hydraulic brake system
 - When disassembling the master cylinder or caliper cylinder, always replace the brake fluid. Check the brake fluid level regularly and fill as required.
 - Replace the oil seals on the inner parts of the master cylinder and caliper cylinder every two years.
 - Replace the brake hoses every four years or if cracked or damaged.
-

PERIODIC MAINTENANCE AND MINOR REPAIR

Removing and installing panels

EAU18771

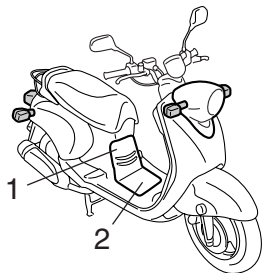

ZALUM00**

1. Panel A
2. Panel B

The panels shown above need to be removed to perform some of the maintenance jobs described in this chapter. Refer to this section each time a panel needs to be removed and installed.

Panel A

EAU19210

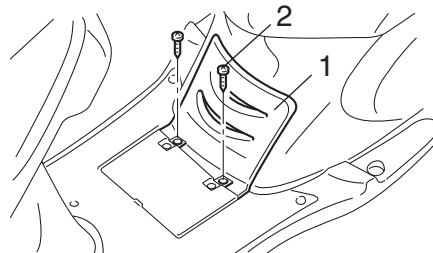

ZALUM00**

1. Panel A
2. Screw (x2)

To remove the panel

Remove the screws, and then take the panel off.

To install the panel

Place the panel in the original position, and then install the screws.

Panel B

EAU19210

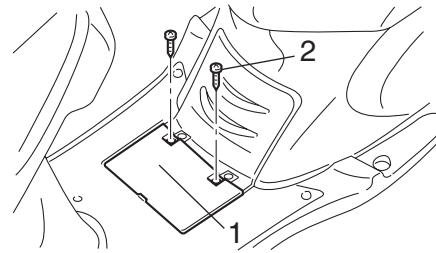

ZALUM00**

1. Panel B
2. Screw (x2)

To remove the panel

Remove the screws, and then take the panel off.

To install the panel

Place the panel in the original position, and then install the screws.

Checking the spark plug

EAUT1170

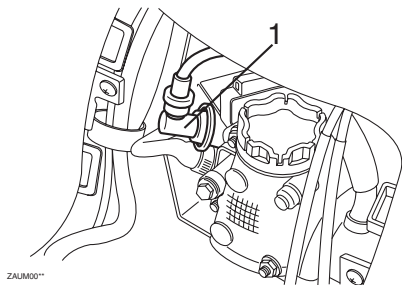

1. Spark plug cap

The spark plug is an important engine component, which is easy to check. Since heat and deposits will cause any spark plug to slowly erode, the spark plug should be removed and checked in accordance with the periodic maintenance and lubrication chart. In addition, the condition of the spark plug can reveal the condition of the engine.

To remove the spark plug

1. Remove panel A. (See page 6-6.)
2. Remove the spark plug cap.
3. Remove the spark plug as shown, with the spark plug wrench included in the owner's tool kit.

To check the spark plug

1. Check that the porcelain insulator around the center electrode of the spark plug is a medium-to-light tan (the ideal color when the vehicle is ridden normally).

NOTE:

If the spark plug shows a distinctly different color, the engine could be defective. Do not attempt to diagnose such problems yourself. Instead, have a Yamaha dealer check the vehicle.

2. Check the spark plug for electrode erosion and excessive carbon or other deposits, and replace it if necessary.

Specified spark plug:
CR7E (NGK)

To install the spark plug

1. Measure the spark plug gap with a wire thickness gauge and, if necessary, adjust the gap to specification.

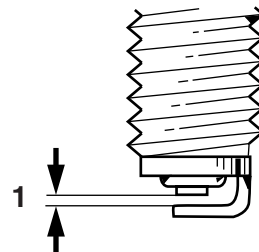

ZALUM0037

1. Spark plug gap

Spark plug gap:
0.7~0.8 mm (0.028~0.032 in)

2. Clean the surface of the spark plug gasket and its mating surface, and then wipe off any grime from the spark plug threads.
3. Install the spark plug with the spark plug wrench, and then tighten it to the specified torque.

Tightening torque:
Spark plug:
13 Nm (1.3m • kgf, 9.4ft • lbf)

PERIODIC MAINTENANCE AND MINOR REPAIR

NOTE:

If a torque wrench is not available when installing a spark plug, a good estimate of the correct torque is 1/4~1/2 turn past finger tight. However, the spark plug should be tightened to the specified torque as soon as possible.

4. Install the spark plug cap.
5. Install the panel.

EAUT1301

Air filter and V-belt case air filter elements

Air filter and V-belt case air filter

The air filter and V-belt case air filter elements should be cleaned at the intervals specified in the periodic maintenance and lubrication chart. Clean both filter elements more frequently if you are riding in unusually wet or dusty areas.

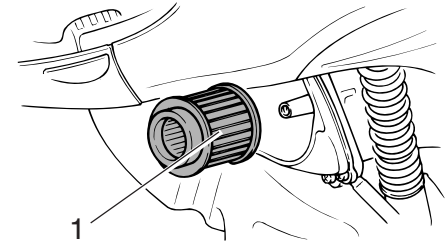

ZAJM001

1. Air filter element

Cleaning the air filter element

1. Place the scooter on the centerstand.

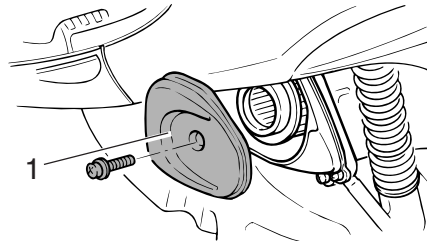

ZAJM002

1. Air filter case cover
2. Remove the air filter case cover by removing the screw.

3. Pull the air filter element out, and then blow the dirt out with compressed air as shown.
4. Check the air filter element for damage and replace it if necessary.
5. Insert the air filter element into the air filter case.

PERIODIC MAINTENANCE AND MINOR REPAIR

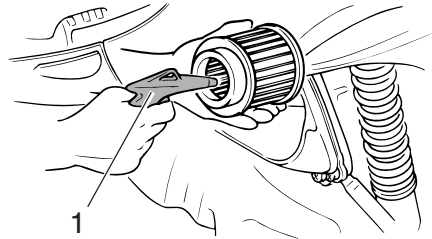

ZALUM00**

1. Compressed air

ECA10480

CAUTION:

- Make sure that the air filter element is properly seated in the air filter case.
- The engine should never be operated without the air filter element installed, otherwise the piston(s) and/or cylinder(s) may become excessively worn.

6. Install the air filter case cover by installing the screw.

Cleaning the V-belt case air filter element

1. Remove the kickstarter lever by removing the bolt.
2. Remove the crankcase cover by removing the screws.

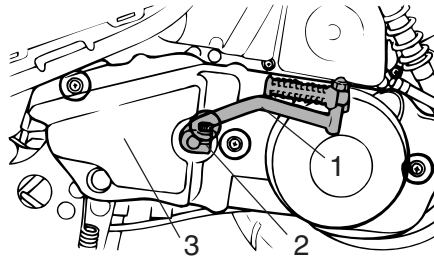

ZALUM00**

1. Kickstarter
2. Bolt
3. Crankcase cover

3. Remove the filter element holder by removing the screw.
4. Pull the air filter element out, and then clean it with solvent. After cleaning, remove the remaining solvent by squeezing the element.

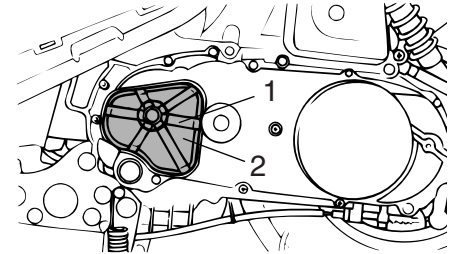

ZALUM00**

1. Filter element holder
2. Filter element

EWA10430

⚠ WARNING

Use only a dedicated parts cleaning solvent. To avoid the risk of fire or explosion, do not use gasoline or solvents with a low flash point.

CAUTION:

To avoid damaging the air filter element, handle it gently and carefully, and do not twist it.

5. Apply oil of the recommended type to the entire surface of the sponge material, and then squeeze the excess oil out.

PERIODIC MAINTENANCE AND MINOR REPAIR

NOTE: _____

The air filter element should be wet but not dripping.

Recommended oil:
Engine oil

6. Insert the element into the air filter case.
7. Install the filter element holder by installing the screw.
8. Install the crankcase cover by installing the screws.
9. Install the kickstarter lever by installing the bolt, then tightening the bolt to the specified torque.

Tightening torque:
Kickstarter bolt:
23 Nm (2.3m • kgf, 16.6ft • lbf)

Replacing the tail/brake light bulb

EAU24131

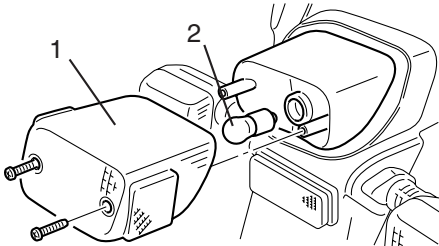

ZALUM00**

1. Light lens
2. Bulb

1. Remove the tail/brake light lens by removing the screws.
2. Remove the defective bulb by pushing it in and turning it counterclockwise.
3. Insert a new bulb into the socket, push it in, and then turn it clockwise until it stops.
4. Install the lens by installing the screws.

ECA10680

CAUTION: _____

Do not overtighten the screws, otherwise the lens may break.

Replacing a turn signal light bulb

EAU24201

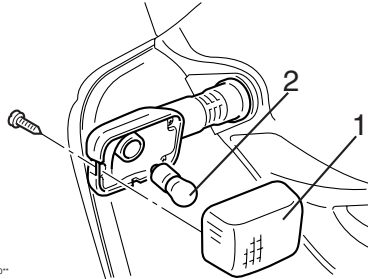

ZALUM00**

1. Front light lens
2. Bulb

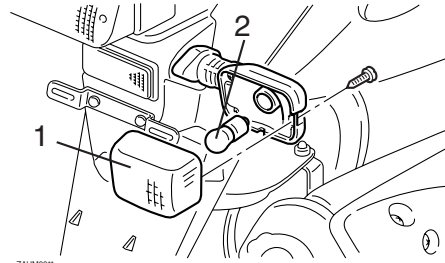

ZALUM00**

1. Rear light lens
2. Bulb

1. Remove the turn signal light lens by removing the screw.
2. Remove the defective bulb by pushing it in and turning it counterclockwise.
3. Insert a new bulb into the socket, push it in, and then turn it clockwise until it stops.
4. Install the lens by installing the screw.

ECA11190

CAUTION: _____

Do not overtighten the screw, otherwise the lens may break.

PERIODIC MAINTENANCE AND MINOR REPAIR

Checking the front brake pads and rear brake shoes

EAU22380

The front brake pads and the rear brake shoes must be checked for wear at the intervals specified in the periodic maintenance and lubrication chart.

Front brake pads

EAU22410

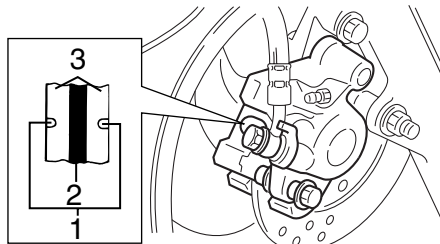

ZALIM00**

1. Wear indicator
2. Brake disk
3. Brake pads

Each front brake pad is provided with a wear indicator, which allows you to check the brake pad wear without having to disassemble the brake. To check the brake pad wear, check the position of the wear indicator while applying the brake. If a brake pad has worn to the point that the wear indicator almost touches the brake disc, have a Yamaha dealer replace the brake pads as a set.

Rear brake shoes

EAU22540

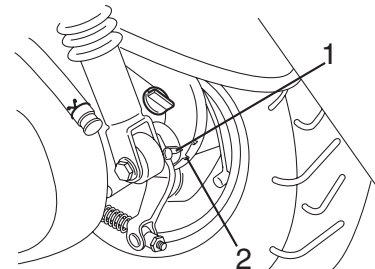

ZALIM00**

1. Wear indicator
2. Wear limit line

The rear brake is provided with a wear indicator, which allows you to check the brake shoe wear without having to disassemble the brake. To check the brake shoe wear, check the position of the wear indicator while applying the brake. If a brake shoe has worn to the point that the wear indicator reaches the wear limit line, have a Yamaha dealer replace the brake shoes as a set.

Checking the brake fluid level

EAU32341

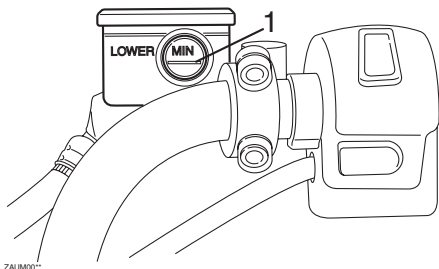

1. Minimum level mark

Insufficient brake fluid may allow air to enter the brake system, possibly causing it to become ineffective.

Before riding, check that the brake fluid is above the minimum level mark and replenish if necessary. A low brake fluid level may indicate worn brake pads and/or brake system leakage. If the brake fluid level is low, be sure to check the brake pads for wear and the brake system for leakage.

Observe these precautions:

- When checking the fluid level, make sure that the top of the master cylinder is level by turning the handlebars.

Use only the recommended quality brake fluid, otherwise the rubber seals may deteriorate, causing leakage and poor braking performance.

Recommended brake fluid:
DOT 4

- Refill with the same type of brake fluid. Mixing fluids may result in a harmful chemical reaction and lead to poor braking performance.
- Be careful that water does not enter the master cylinder when refilling. Water will significantly lower the boiling point of the fluid and may result in vapor lock.
- Brake fluid may deteriorate painted surfaces or plastic parts. Always clean up spilled fluid immediately.
- As the brake pads wear, it is normal for the brake fluid level to gradually go down. However, if the

brake fluid level goes down suddenly, have a Yamaha dealer check the cause.

EAU22720

Changing the brake fluid

Have a Yamaha dealer change the brake fluid at the intervals specified in the NOTE after the periodic maintenance and lubrication chart. In addition, have the oil seals of the brake master cylinder and caliper as well as the brake hose replaced at the intervals listed below or whenever they are damaged or leaking.

- Oil seals: Replace every two years.
- Brake hose: Replace every four years.

PERIODIC MAINTENANCE AND MINOR REPAIR

EAU23090

Checking and lubricating the cables

The operation of all control cables and the condition of the cables should be checked before each ride, and the cables and cable ends should be lubricated if necessary. If a cable is damaged or does not move smoothly, have a Yamaha dealer check or replace it.

Recommended lubricant:
Yamaha Chain and Cable Lube or
engine oil SAE 10W-30 (API SE)

EWA10710

6

⚠ WARNING

Damage to the outer housing of cables may result in internal rusting and cause interference with cable movement. Replace damaged cables as soon as possible to prevent unsafe conditions.

EAU23110

Checking and lubricating the throttle grip and cable

The operation of the throttle grip should be checked before each ride. In addition, the cable should be lubricated or replaced at the intervals specified in the periodic maintenance chart.

EAU23170

Lubricating the front and rear brake levers

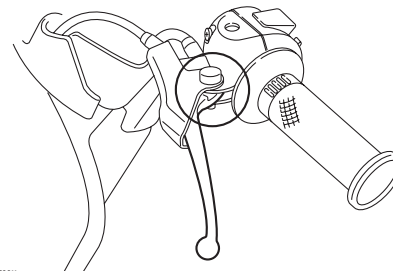

The pivoting points of the front and rear brake levers must be lubricated at the intervals specified in the periodic maintenance and lubrication chart.

Recommended lubricant:
Lithium-soap-based grease (all-purpose grease)

Checking and lubricating the centerstand and sidestand

EAU23210

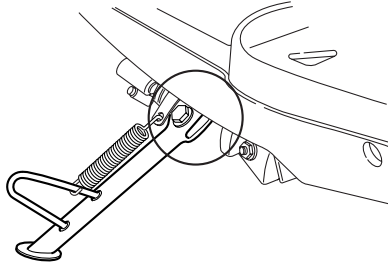

ZALM00**

The operation of the centerstand and sidestand should be checked before each ride, and the pivots and metal-to-metal contact surfaces should be lubricated if necessary.

EWA10740

⚠ WARNING

If the centerstand or sidestand does not move up and down smoothly, have a Yamaha dealer check or repair it.

Recommended lubricant:
Lithium-soap-based grease (all-purpose grease)

Checking the front fork

EAU23271

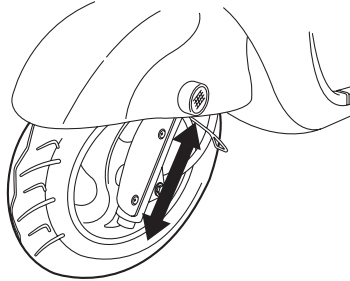

ZALM00**

The condition and operation of the front fork must be checked as follows at the intervals specified in the periodic maintenance and lubrication chart.

To check the condition

EWA10750

⚠ WARNING

Securely support the motorcycle so that there is no danger of it falling over.

Check the inner tubes for scratches, damage and excessive oil leakage.

To check the operation

1. Place the motorcycle on a level surface and hold it in an upright position.
2. While applying the front brake, push down hard on the handlebars several times to check if the front fork compresses and rebounds smoothly.

ECA10590

CAUTION:

If any damage is found or the front fork does not operate smoothly, have a Yamaha dealer check or repair it.

PERIODIC MAINTENANCE AND MINOR REPAIR

Checking the steering

EAU23280

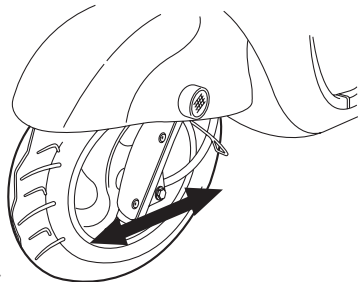

ZALM00**

Worn or loose steering bearings may cause danger. Therefore, the operation of the steering must be checked as follows at the intervals specified in the periodic maintenance and lubrication chart.

1. Place a stand under the engine to raise the front wheel off the ground.

EWA10750

⚠ WARNING

Securely support the motorcycle so that there is no danger of it falling over.

2. Hold the lower ends of the front fork legs and try to move them forward and backward. If any free play can be felt, have a Yamaha dealer check or repair the steering.

Replacing the headlight bulb

EAU23780

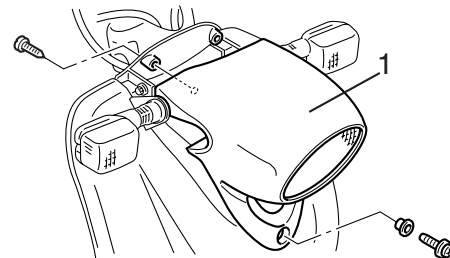

ZALM00**

1. Headlight unit

This model is equipped with a quartz bulb headlight. If the headlight bulb burns out, replace it as follows.

1. Remove the headlight unit by removing the screws.

EWA10790

EAU20060

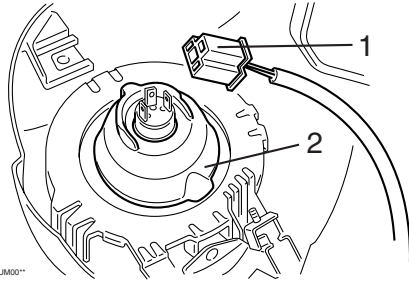

ZAJM00**

1. Headlight coupler
2. Bulb cover

2. Disconnect the headlight coupler, and then remove the bulb cover.

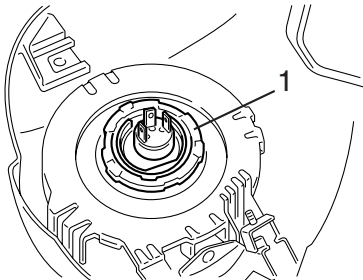

ZAJM00**

1. Bulb holder

3. Remove the headlight bulb holder by turning it counterclockwise, and then remove the defective bulb.

⚠ WARNING

Headlight bulbs get very hot. Therefore, keep flammable products away from a lit headlight bulb, and do not touch the bulb until it has cooled down.

4. Place a new headlight bulb into position, and then secure it with the bulb holder.

ECA10660

CAUTION:

Do not touch the glass part of the headlight bulb to keep it free from oil, otherwise the transparency of the glass, the luminosity of the bulb, and the bulb life will be adversely affected. Thoroughly clean off any dirt and fingerprints on the headlight bulb using a cloth moistened with alcohol or thinner.

5. Install the headlight bulb cover, and then connect the coupler.
6. Install the headlight unit by installing the screws.
7. Have a Yamaha dealer adjust the headlight beam if necessary.

Final transmission oil

The final transmission case must be checked for oil leakage before each ride. If any leakage is found, have a Yamaha dealer check and repair the scooter. In addition, the final transmission oil must be changed as follows at the intervals specified in the periodic maintenance and lubrication chart.

1. Start the engine, warm it up by riding the scooter for several minutes, and then stop the engine.
2. Place the scooter on the centerstand.
3. Place an oil pan under the final transmission case to collect the used oil.

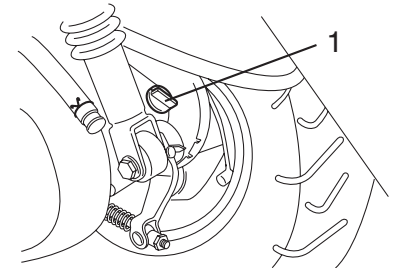

ZAJM00**

1. Final transmission oil filler cap

PERIODIC MAINTENANCE AND MINOR REPAIR

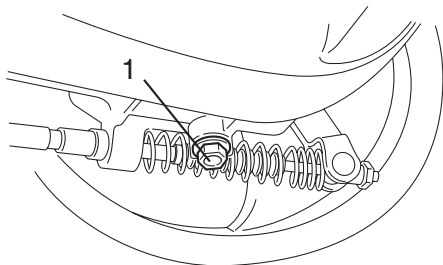

ZALM001*

1. Final transmission gear oil drain bolt
4. Remove the oil filler cap and drain bolt to drain the oil from the final transmission case.
5. Install the final transmission oil drain bolt, and then tighten it to the specified torque.

Tightening torque:

Final transmission oil drain bolt:
23 Nm (2.3m • kgf, 16.6ft • lbf)

6. Add the specified amount of the recommended final transmission oil, and then install and tighten the oil filler cap.

Recommended final transmission oil:
See page 8-1.
Oil quantity:
0.13 L (0.14 US qt) (0.1 Imp.qt)

EWA11310

⚠ WARNING

- **Make sure that no foreign material enters the final transmission case.**
 - **Make sure that no oil gets on the tire or wheel.**
7. Check the final transmission case for oil leakage. If oil is leaking, check for the cause.

EAU21250

Adjusting the carburetor

The carburetor is an important part of the engine and its emission control system, which requires very sophisticated adjustment. Therefore, carburetor adjustments should be left to Yamaha dealer, who has the necessary professional knowledge and experience.

EAU21380

Adjusting the throttle cable free play

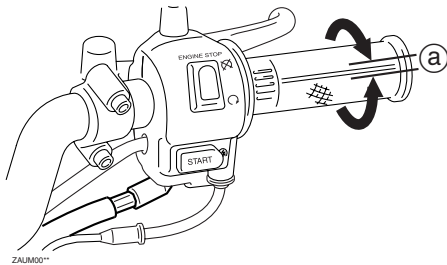

a. 1.5 ~ 3.5mm

The throttle cable free play should measure 1.5~3.5 mm (0.06~0.14 in) at the throttle grip. Periodically check the throttle cable free play and, if necessary, have a Yamaha dealer adjust it.

EAU21860

Tires

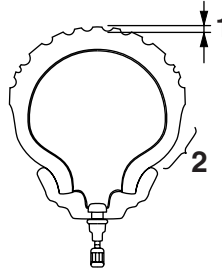

1. Tread depth
2. Side wall

To maximize the performance, durability, and safe operation of your scooter, note the following points regarding the specified tires.

Tire air pressure

The tire air pressure should be checked and, if necessary, adjusted before each ride.

EWA10500

⚠ WARNING

- The tire air pressure must be checked and adjusted on cold tires (i.e., when the temperature

of the tires equals the ambient temperature).

- The tire air pressure must be adjusted in accordance with the riding speed and with the total weight of rider, passenger, cargo, and accessories approved for this model.

Tire air pressure (measured on cold tires)		
Load*	Front	Rear
Up to 90 kg (198 lb)	150 kPa 1.50 kgf/cm ² 22 psi	200 kPa 2.0 kgf/cm ² 29 psi
90 kg (198 lb)– maximum	150 kPa 1.50kgf/cm ² 22psi	225 kPa 2.25 kgf/cm ² 32 psi

Maximum load*	144 kg (317 lb)
---------------	-----------------

* Total weight of rider, passenger, cargo and accessories

EWA10510

⚠ WARNING

Proper loading of your vehicle is important for several characteristics of your vehicle, such as handling, braking, performance and safety. Do not carry loosely packed items that can shift. Securely pack your heaviest

PERIODIC MAINTENANCE AND MINOR REPAIR

EWA10580

items close to the center of the motorcycle, and distribute the weight evenly from side to side. Properly adjust the suspension for your load, and check the condition and pressure of your tires. **NEVER OVERLOAD YOUR VEHICLE.** Make sure that the total weight of the cargo, rider, passenger, and accessories (cowling, saddlebags, etc. if approved for this model) does not exceed the maximum load of the vehicle. Operation of an overloaded motorcycle could cause tire damage, an accident, or even injury.

6

Tire inspection

The tires must be checked before each ride. If a tire tread shows crosswise lines (minimum tread depth), if the tire has a nail or glass fragments in it, or if the sidewall is cracked, have a Yamaha dealer replace the tire immediately.

Minimum tire tread depth (front and rear):
0.8 mm (0.03 in)

NOTE:

The tire tread depth limits may differ from country to country. Always comply with the local regulations.

Tire information

This scooter is equipped with cast wheels and tubeless tires with valves.

EWA10590

⚠ WARNING

Operating the scooter with excessively worn tires decrease riding stability and can lead to loss of control. Have excessively worn tires replaced by a Yamaha dealer immediately. Brakes, tires, and related wheel parts replacement should be left to a Yamaha Service Technician.

FRONT

Manufacturer	Size	Model
Cheng shin	3.50-10	51J

REAR

Manufacturer	Size	Model
Cheng shin	3.50-10	51J

⚠ WARNING

- It is dangerous to ride with a worn-out tire. When a tire tread begins to show crosswise lines, have a Yamaha dealer replace the tire immediately.
- The replacement of all wheel- and brake-related parts, including the tires, should be left to a Yamaha dealer, who has the necessary professional knowledge and experience.

Cast wheels

To maximize the performance, durability, and safe operation of your motorcycle, note the following points regarding the specified wheels.

- The wheel rims should be checked for cracks, bends or warpage before each ride. If any damage is found, have a Yamaha dealer replace the wheel. Do not attempt even the smallest repair to the wheel. A deformed or cracked wheel must be replaced.
- The wheel should be balanced whenever either the tire or wheel has been changed or replaced. An unbalanced wheel can result in poor performance, adverse handling characteristics, and a shortened tire life.
- Ride at moderate speeds after changing a tire since the tire surface must first be “broken in” for it to develop its optimal characteristics.

EAU21960

Adjusting the brake lever free play

EAU22100

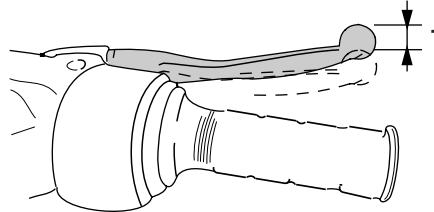

ZAJM0107

1. Free play

The brake lever free play should measure 2~5 mm (0.08~0.2 in) as shown. Periodically check the brake lever free play and, if necessary, have a Yamaha dealer adjust it.

EWA10640

⚠ WARNING

An incorrect brake lever free play indicates a hazardous condition in the brake system. Do not operate the motorcycle until the brake system has been checked or repaired by a Yamaha dealer.

Adjusting the rear brake lever free play

EAU22170

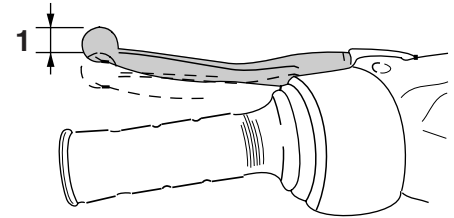

ZAJM0108

1. Free play

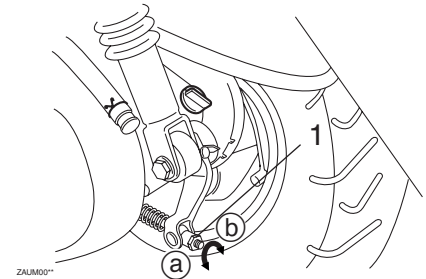

ZAJM0011

1. Adjusting nut

PERIODIC MAINTENANCE AND MINOR REPAIR

The brake lever free play should measure 10~20 mm (0.4~0.8 in) as shown. Periodically check the brake lever free play and, if necessary, adjust it as follows.

To increase the brake lever free play, turn the adjusting nut at the brake shoe plate in direction (a). To decrease the brake lever free play, turn the adjusting nut in direction (b).

EWA10650

⚠ WARNING

If proper adjustment cannot be obtained as described, have a Yamaha dealer make this adjustment.

6

Battery

EAUT1230

EWA10760

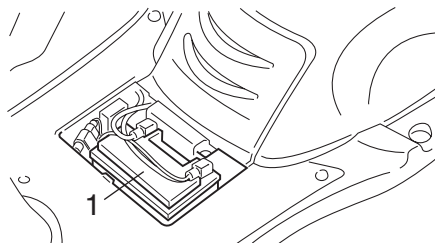

ZALM00

1. Battery

This model is equipped with a sealed-type (MF) battery, which does not require any maintenance. There is no need to check the electrolyte or to add distilled water.

ECA10620

CAUTION:

Never attempt to remove the battery cell seals, as this would permanently damage the battery.

⚠ WARNING

- **Electrolyte is poisonous and dangerous since it contains sulfuric acid, which causes severe burns. Avoid any contact with skin, eyes or clothing and always shield your eyes when working near batteries. In case of contact, administer the following FIRST AID.**
 - **EXTERNAL:** Flush with plenty of water.
 - **INTERNAL:** Drink large quantities of water or milk and immediately call a physician.
 - **EYES:** Flush with water for 15 minutes and seek prompt medical attention.
- **Batteries produce explosive hydrogen gas. Therefore, keep sparks, flames, cigarettes, etc., away from the battery and provide sufficient ventilation when charging it in an enclosed space.**
- **KEEP THIS AND ALL BATTERIES OUT OF THE REACH OF CHILDREN.**

The battery is located under the footboard. Remove panel B to access the battery. (See page 6-6.)

To charge the battery

Have a Yamaha dealer charge the battery as soon as possible if it seems to have discharged. Keep in mind that the battery tends to discharge more quickly if the vehicle is equipped with optional electrical accessories.

To store the battery

1. If the vehicle will not be used for more than one month, remove the battery, fully charge it, and then place it in a cool, dry place.
2. If the battery will be stored for more than two months, check it at least once a month and fully charge it if necessary.
3. Fully charge the battery before installation.
4. After installation, make sure that the battery leads are properly connected to the battery terminals.

ECA10630

CAUTION:

- **Always keep the battery charged. Storing a discharged battery can cause permanent battery damage.**
- **To charge a sealed-type (MF) battery, a special (constant-voltage) battery charger is required. Using a conventional battery charger will damage the battery. If you do not have access to a sealed-type (MF) battery charger, have a Yamaha dealer charge your battery.**

EAUT1240

Replacing the fuse

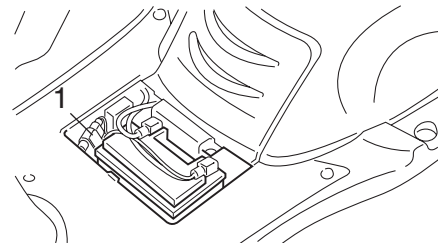

1. Fuse

The fuse holder is located beside the battery. Remove panel B to access the fuse. (See page 6-6.)

If the fuse is blown, replace it as follows.

1. Turn the key to "OFF" and turn off all electrical circuits.
2. Remove the blown fuse, and then install a new fuse of the specified amperage.

Specified fuse:
10 A

PERIODIC MAINTENANCE AND MINOR REPAIR

ECA10640

CAUTION:

Do not use a fuse of a higher amperage rating than recommended to avoid causing extensive damage to the electrical system and possibly a fire.

3. Turn the key to “ON” and turn on the electrical circuits to check if the devices operate.
4. If the fuse immediately blows again, have a Yamaha dealer check the electrical system.

EAUT1180

Engine oil and oil strainer

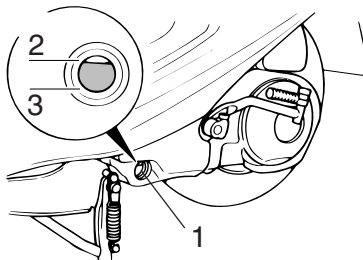

ZALM00*

1. Level check window
2. Maximum level
3. Minimum level

The engine oil level should be checked before each ride. In addition, the oil must be changed and the oil strainer cleaned at the intervals specified in the periodic maintenance and lubrication chart.

To check the engine oil level

1. Place the vehicle on the centerstand.

NOTE:

Make sure that the vehicle is positioned straight up when checking the oil level. A slight tilt to the side can result in a false reading.

2. Start the engine, warm it up for several minutes, and then turn it off.
3. Wait a few minutes until the oil settles, and then check the oil level through the check window located at the bottom-left side of the crankcase.

NOTE:

The engine oil should be between the minimum and maximum level marks.

4. If the engine oil is below the minimum level mark, add sufficient oil of the recommended type to raise it to the correct level.

PERIODIC MAINTENANCE AND MINOR REPAIR

To change the engine oil and clean the oil strainer

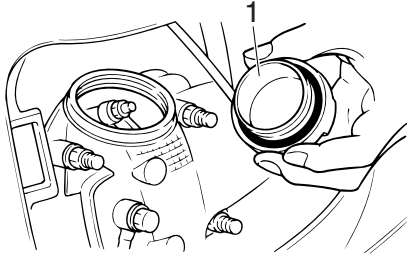

ZALUM00™

1. Oil filler cap

1. Start the engine, warm it up for several minutes, and then turn it off.
2. Place an oil pan under the engine to collect the used oil.
3. Remove panel A. (See page 6-6.)
4. Remove the engine oil filler cap and drain bolts to drain the oil from the crankcase.

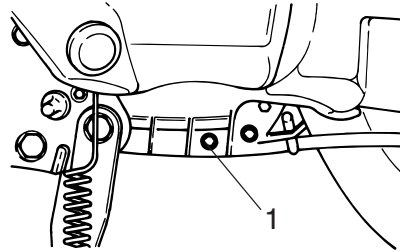

ZALUM00™

1. Drain bolt A

ECA10410

CAUTION:

When removing the engine oil drain bolt, the O-ring, spring, and oil strainer will fall out. Take care not to lose these parts.

5. Clean the oil strainer with solvent, and then check it for damage and replace it if necessary.

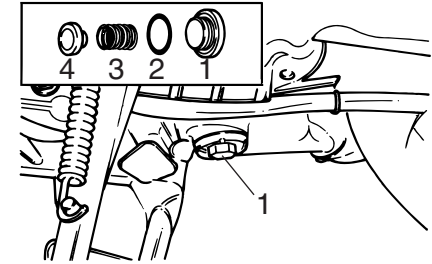

ZALUM00™

1. Drain bolt B
2. O-ring
3. Spring
4. Strainer

6. Check the O-ring for damage and replace it if necessary.
7. Install the oil strainer, spring, O-ring and engine oil drain bolts, and then tighten the drain bolts to the specified torque.

Tightening torque:

Engine oil drain bolt A:

23 Nm (2.3m • kgf, 16.6ft • lbf)

Engine oil drain bolt B:

32 Nm (3.2m • kgf, 23.1ft • lbf)

PERIODIC MAINTENANCE AND MINOR REPAIR

NOTE: _____
Make sure that the O-ring is properly seated.

8. Add the specified amount of the recommended engine oil, and then install and tighten the engine oil filler cap.

Recommended engine oil:

See page 8-1.

Oil change quantity:

1.0 L (1.09 US qt) (0.92 Imp.qt)

ECA11670

6

CAUTION: _____

- **Do not use oils with a diesel specification of “CD” or oils of a higher quality than specified. In addition, do not use oils labeled “ENERGY CONSERVING II” or higher.**
 - **Be sure no foreign material enters the crankcase.**
-

9. Start the engine, and then let it idle for several minutes while checking it for oil leakage. If oil is leaking, immediately turn the engine off and check for the cause.
10. Turn the engine off, and then check the oil level and correct it if necessary.
11. Install the panel.

Troubleshooting

EAU25860

Although Yamaha scooters receive a thorough inspection before shipment from the factory, trouble may occur during operation. Any problem in the fuel, compression, or ignition systems, for example, can cause poor starting and loss of power.

The following troubleshooting chart represents a quick and easy procedure for checking these vital systems yourself. However, should your scooter require any repair, take it to a Yamaha dealer, whose skilled technicians have the necessary tools, experience, and know-how to service the scooter properly.

Use only genuine Yamaha replacement parts. Imitation parts may look like Yamaha parts, but they are often inferior, have a shorter service life and can lead to expensive repair bills.

Troubleshooting chart

⚠ WARNING

Keep away open flames and do not smoke while checking or working on the fuel system.

1. Fuel

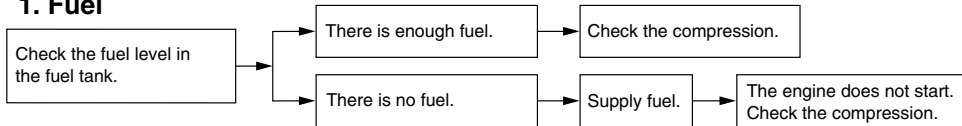

2. Compression

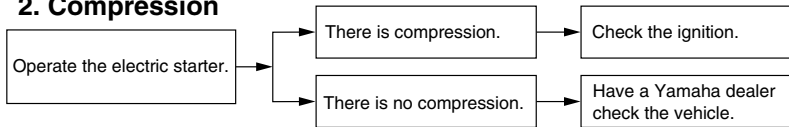

3. Ignition

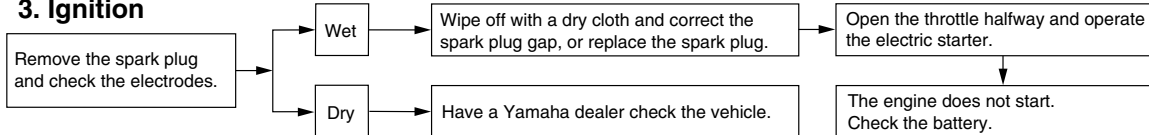

4. Battery

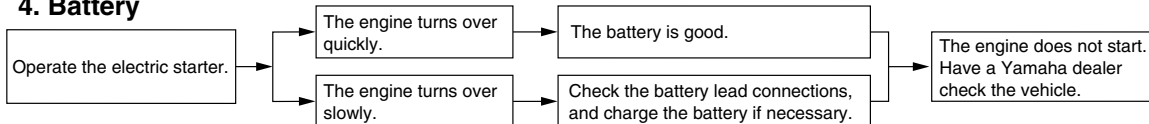

SCOOTER CARE AND STORAGE

EAU26090

Care

While the open design of a scooter reveals the attractiveness of the technology, it also makes it more vulnerable. Rust and corrosion can develop even if high-quality components are used. A rusty exhaust pipe may go unnoticed on a car, however, it detracts from the overall appearance of a scooter. Frequent and proper care does not only comply with the terms of the warranty, but it will also keep your scooter looking good, extend its life and optimize its performance.

Before cleaning

1. Cover the muffler outlet with a plastic bag after the engine has cooled down.
2. Make sure that all caps and covers as well as all electrical couplers and connectors, including the spark plug cap, are tightly installed.
3. Remove extremely stubborn dirt, like oil burnt onto the crankcase, with a degreasing agent and a brush, but never apply such products onto seals, gaskets and wheel axles. Always rinse the dirt and degreaser off with water.

Cleaning

ECA10780

CAUTION:

- **Avoid using strong acidic wheel cleaners, especially on spoked wheels. If such products are used on hard-to-remove dirt, do not leave the cleaner on the affected area any longer than instructed. Also, thoroughly rinse the area off with water, immediately dry it, and then apply a corrosion protection spray.**
- **Improper cleaning can damage windshields, cowlings, panels and other plastic parts. Use only a soft, clean cloth or sponge with mild detergent and water to clean plastic.**
- **Do not use any harsh chemical products on plastic parts. Be sure to avoid using cloths or sponges which have been in contact with strong or abrasive cleaning products, solvent or thinner, fuel (gasoline), rust removers or inhibitors, brake fluid, antifreeze or electrolyte.**
- **Do not use high-pressure wash-**

ers or steam-jet cleaners since they cause water seepage and deterioration in the following areas: seals (of wheel and swingarm bearings, fork and brakes), electric components (couplers, connectors, instruments, switches and lights), breather hoses and vents.

- **For scooters equipped with a windshield: Do not use strong cleaners or hard sponges as they will cause dulling or scratching. Some cleaning compounds for plastic may leave scratches on the windshield. Test the product on a small hidden part of the windshield to make sure that it does not leave any marks. If the windshield is scratched, use a quality plastic polishing compound after washing.**

After normal use

Remove dirt with warm water, a mild detergent, and a soft, clean sponge, and

then rinse thoroughly with clean water. Use a toothbrush or bottlebrush for hard-to-reach areas. Stubborn dirt and insects will come off more easily if the area is covered with a wet cloth for a few minutes before cleaning.

After riding in the rain, near the sea or on salt-sprayed roads

Since sea salt or salt sprayed on the roads during winter are extremely corrosive in combination with water, carry out the following steps after each ride in the rain, near the sea or on salt-sprayed roads.

NOTE: _____
Salt sprayed on roads in the winter may remain well into spring.

1. Clean the scooter with cold water and a mild detergent after the engine has cooled down.

ECA10790

CAUTION: _____
Do not use warm water since it increases the corrosive action of the salt.

2. Apply a corrosion protection spray on all metal, including chrome- and nickel-plated, surfaces to prevent corrosion.

After cleaning

1. Dry the scooter with a chamois or an absorbing cloth.
2. Use a chrome polish to shine chrome, aluminum and stainless-steel parts, including the exhaust system. (Even the thermally induced discoloring of stainless-steel exhaust systems can be removed through polishing.)
3. To prevent corrosion, it is recommended to apply a corrosion protection spray on all metal, including chrome- and nickel-plated, surfaces.
4. Use spray oil as a universal cleaner to remove any remaining dirt.
5. Touch up minor paint damage caused by stones, etc.
6. Wax all painted surfaces.
7. Let the scooter dry completely before storing or covering it.

⚠ WARNING _____

- **Make sure that there is no oil or wax on the brakes or tires. If necessary, clean the brake discs and brake linings with a regular brake disc cleaner or acetone, and wash the tires with warm water and a mild detergent.**
- **Before operating the scooter test its braking performance and cornering behavior.**

ECA10800

CAUTION: _____

- **Apply spray oil and wax sparingly and make sure to wipe off any excess.**
- **Never apply oil or wax to any rubber and plastic parts, but treat them with a suitable care product.**
- **Avoid using abrasive polishing compounds as they will wear away the paint.**

SCOOTER CARE AND STORAGE

NOTE: _____
Consult a Yamaha dealer for advice on what products to use.

EAU26300

Storage Short-term

Always store your scooter in a cool, dry place and, if necessary, protect it against dust with a porous cover.

ECA10820

CAUTION: _____

- **Storing the scooter in a poorly ventilated room or covering it with a tarp, while it is still wet, will allow water and humidity to seep in and cause rust.**
 - **To prevent corrosion, avoid damp cellars, stables (because of the presence of ammonia) and areas where strong chemicals are stored.**
-

Long-term

Before storing your scooter for several months:

1. Follow all the instructions in the “Care” section of this chapter.
2. Drain the carburetor float chamber by loosening the drain bolt; this will prevent fuel deposits from building

up. Pour the drained fuel into the fuel tank.

3. Fill up the fuel tank and add fuel stabilizer (if available) to prevent the fuel tank from rusting and the fuel from deteriorating.
4. Perform the following steps to protect the cylinder, piston rings, etc. from corrosion.
 - a. Remove the spark plug cap and spark plug.
 - b. Pour a teaspoonful of engine oil into the spark plug bore.
 - c. Install the spark plug cap onto the spark plug, and then place the spark plug on the cylinder head so that the electrodes are grounded. (This will limit sparking during the next step.)
 - d. Turn the engine over several times with the starter. (This will coat the cylinder wall with oil.)
 - e. Remove the spark plug cap from the spark plug, and then install the spark plug and the spark plug cap.

EWA10950

⚠ WARNING

To prevent damage or injury from sparking, make sure to ground the spark plug electrodes while turning the engine over.

°F) or more than 30 °C (90 °F)]. For more information on storing the battery, see page 6-23.

NOTE:

Make any necessary repairs before storing the scooter.

5. Lubricate all control cables and the pivoting points of all levers and pedals as well as of the sidestand/centerstand.
6. Check and, if necessary, correct the tire air pressure, and then lift the scooter so that both of its wheels are off the ground. Alternatively, turn the wheels a little every month in order to prevent the tires from becoming degraded in one spot.
7. Cover the muffler outlet with a plastic bag to prevent moisture from entering it.
8. Remove the battery and fully charge it. Store it in a cool, dry place and charge it once a month. Do not store the battery in an excessively cold or warm place [less than 0 °C (30

SPECIFICATIONS

Dimensions:

- Overall length:
1,755 mm (69.1 in)
- Overall width:
699 mm (27.5 in)
- Overall height:
1,063 mm (41.8 in)
- Seat height:
759 mm (29.8 in)
- Wheel base:
1,230 mm (48.4 in)
- Ground clearance:
95 mm (3.8 in)
- Minimum turning radius:
1,800 mm (72 in)

Weight:

- with oil and full fuel tank:
109 kg (240 lb)

Engine:

- Engine type
Air-cooled 4-stroke, SOHC
- Cylinder arrangement:
Forward-inclined single cylinder
- Displacement:
125 cm³
- Bore Stroke
51.5×60.0 mm (2.0×2.4 in)
- Compression ratio:
9.8:1
- Starting system:
Electric / kick starter
- Lubrication system:
Wet sump

Oil type or grade

Engine oil

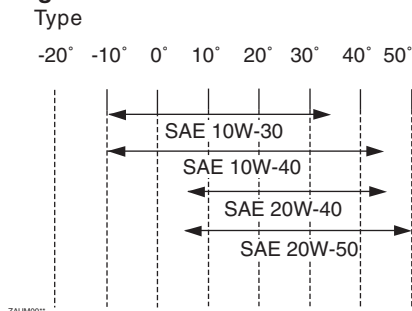

Recommended engine oil classification
API Service SE, SF type or higher

Final gear oil

- Type
SAE 85 W 140

Oil quantity

- Engine oil
- Periodic oil change
1.0 L (1.09 US qt, 0.92 Imp.qt)
- Total amount
1.2 L (1.31 US qt, 1.10 Imp.qt)

Final gear case oil

- Periodic oil change
0.13 L
- Total amount
0.15 L

Air filter

- Paper type element

Fuel

- Type
Regular unleaded gasoline(91 or higher)
- Fuel tank capacity
4.5 L (1.18 US qt, 0.98 Imp.gal)

Carburetor

- Type×quantity
BS26×1
- Manufacturer
Mikuni

Spark plug

- Type / Manufacturer
CR7E / NGK
- Gap
0.7 ~ 0.8 mm (0.028 ~ 0.032 in)

Transmission

- Primary reduction system
Helical gear
- Primary reduction ratio
40/15(2.666)
- Secondary reduction system
Spur gear
- Secondary reduction ratio
38/13(2.923)
- Transmission type
Single speed automatic(V-belt type)
- Operation
Centrifugal automatic type

Chassis

- Frame type
Steel tube underbone
- Caster angle
32°
- Trail
75 mm

Front tire

Type
Tubeless
Size
3.50-10 51J
Manufacturer
Cheng shin

Rear tire

Type
Tubeless
Size
3.50-10 51J
Manufacturer
Cheng shin
Maximum load*
144 kg (317 lb)

Tire air pressure(Cold tire)

Up to 90 kg (198 lb) load*
Front
150 kPa(1.50 kg / cm², 22 psi)
Rear
200 kPa(2.00 kg / cm², 29 psi)
90 kg load ~ maximum load*
Front
150 kPa(1.50 kg / cm², 22 psi)
Rear
225 kPa(2.25 kg / cm², 32 psi)

*Load is total weight of cargo, rider and accessories.

Front wheel

Type
Cast
Size
J10×MT 2.5

Rear wheel

Type
Cast
Size
J10×MT 2.5

Front brake

Type
Single disc brake
Operation
Right hand operation
Fluid
DOT 4

Rear brake

Type
Drum
Operation
Left hand operation

Front suspension

Type
Telescopic fork

Rear suspension

Type
Unit swing

Shock absorbers

Front
Coil spring / oil damper
Rear
Coil spring / oil damper

Wheel travel

Front
59 mm
Rear
54 mm

Electrical system

Ignition system
C.D.I.
Charging system
Type
C.D.I. magneto generator
Standard output
14 V, 120W / 5,000 r/min

Battery

Type
GTX 7A-BS
Voltage, capacity
12 V, 6 AH

Headlight type

Bulb

Bulb voltage, wattage quantity

Headlight
12 V, 60 / 65 W×1
Tail / brake light
12 V, 8 / 27 W×1
Turn signal light
12 V, 10 W×4
Meter light
14 V, 3 W×1
Fuel meter light
14 V, 3 W×1
High beam indicator light
12 V, 3 W×1
Turn indicator light
12 V, 1.7 W×1

Fuse

10A 1

CONSUMER INFORMATION

EAU26351

Identification numbers

Record the key identification number, vehicle identification number and model label information in the spaces provided below for assistance when ordering spare parts from a Yamaha dealer or for reference in case the vehicle is stolen.

KEY IDENTIFICATION NUMBER:

VEHICLE IDENTIFICATION NUMBER:

MODEL LABEL INFORMATION:

Key identification number

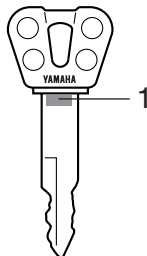

1. Key identification number

The key identification number is stamped into the key. Record this number in the space provided and use it for reference when ordering a new key.

EAU26390

Vehicle identification number

EAU26410

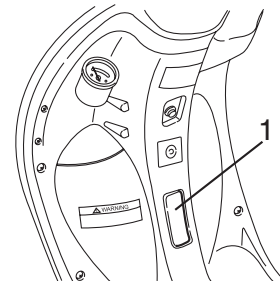

1. Vehicle identification number

The vehicle identification number is stamped into the frame.

NOTE: _____
The vehicle identification number is used to identify your motorcycle and may be used to register your motorcycle with the licensing authority in your area.

EAU26460

Model label

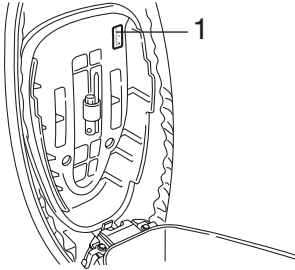

ZAJM00**

1. Model label

The model label is affixed to the location shown. Record the information on this label in the space provided. This information will be needed when ordering spare parts from a Yamaha dealer.

CONSUMER INFORMATION

EAU26550

Reporting safety defects

If you believe that your vehicle has a defect which could cause a crash or could cause injury or death, you should immediately inform the National Highway Traffic Safety Administration (NHTSA) in addition to notifying Yamaha Motor Corporation, U.S.A. If NHTSA receives similar complaints, it may open an investigation, and if it finds that a safety defect exists in a group of vehicles, it may order a recall and remedy campaign. However, NHTSA cannot become involved in individual problems between you, your dealer, or Yamaha Motor Corporation, U.S.A.

To contact NHTSA, you may either call the Auto Safety Hotline toll-free at 1-800-424-9393 (or 366-0123 in Washington, D.C. area) or write to: NHTSA, U.S. Department of Transportation, Washington, D.C. 20590. You can also obtain other information about motor vehicle safety from the Hotline.

Motorcycle noise regulation

TAMPERING WITH NOISE CONTROL SYSTEM PROHIBITED:

Federal law prohibits the following acts or the causing thereof: (1) The removal or rendering inoperative by any person other than for purposes of maintenance, repair, or replacement of any device or element of design incorporated into any new vehicle for the purpose of noise control prior to its sale or delivery to the ultimate purchaser or while it is in use or (2) the use of the vehicle after such device or element of design has been removed or rendered inoperative by any person.

“AMONG THOSE ACTS PRESUMED TO CONSTITUTE TAMPERING ARE THE ACTS LISTED BELOW”.

These acts include tampering with the following systems; i.e., modification, removal, etc.

Exhaust system	Muffler Exhaust pipe Silencer
Intake system	Air cleaner case Air cleaner element Intake duct

CONSUMER INFORMATION

EAU26661

YAMAHA MOTOR CORPORATION, U.S.A. STREET AND ENDURO MOTORCYCLE LIMITED WARRANTY

Yamaha Motor Corporation, U.S.A. hereby warrants that each new Yamaha Riva purchased from an authorized Yamaha Riva dealer in the continental United States will be free from defects in material and workmanship for the period of time stated herein, subject to certain stated limitations.

THE PERIOD OF WARRANTY for Yamaha Riva shall be one (1) year from the date of purchase, with no mileage limitation.

MODELS EXCLUDED FROM WARRANTY include those used for non-Yamaha-authorized renting, leasing, or other commercial purposes.

DURING THE PERIOD OF WARRANTY any authorized Yamaha motorcycle dealer will, free of charge, repair or replace any part adjudged defective by Yamaha due to faulty workmanship or material from the factory. Parts used in warranty repairs will be warranted for the balance of the product's warranty period. All parts replaced under warranty become property of Yamaha Motor Corp. U.S.A.

GENERAL EXCLUSIONS from this warranty shall include any failures caused by:

- Competition or racing use.
- Installation of parts or accessories that are not qualitatively equivalent to genuine Yamaha parts.
- Abnormal strain, neglect, or abuse.
- Lack of proper maintenance.
- Accident or collision damage.

SPECIFIC EXCLUSIONS from this warranty shall include parts replaced due to normal wear or routine maintenance.

THE CUSTOMER'S RESPONSIBILITY under this warranty shall be to:

- Operate and maintain the Riva as specified in the appropriate Owner's Manual, and

- Give notice to an authorized Yamaha Riva dealer of any and all apparent defects within ten (10) days after discovery, and make the machine available at that time for inspection and repairs at such dealer's place of business.

WARRANTY TRANSFER: To transfer the warranty from the original purchaser to any subsequent purchaser, it is imperative that the machine be inspected and registered for warranty by an authorized Yamaha Riva dealer. In order for this warranty to remain in effect, this inspection and registration must take place within (10) days after transfer. An inspection and registration fee will be charged for this service.

EMISSIONS CONTROL SYSTEM WARRANTY

Yamaha Motor Corporation, U.S.A. also warrants to the ultimate purchaser and each subsequent purchaser of each Yamaha Riva covered by this warranty with a displacement of 50cc or greater, that the vehicle is designed, built, and equipped so as to conform at the time of sale with all U.S. emissions standards applicable at the time of manufacture and that it is free from defects in materials and workmanship which would cause it not to meet these standards within the periods listed immediately below. Failure other than those resulting from defects in material or workmanship which arise solely as a result of owner abuse and /or lack of proper maintenance are not covered by this warranty.

ENGINE

DISPLACEMENT

50cc to 169cc 12,000 km (7,465 miles)
or five years, whichever occurs first

170cc to 279cc 18,000 km (11,185 miles)
or five years, whichever occurs first

280cc or over 30,000 km (18,641 miles)
or five years, whichever occurs first

YAMAHA MOTOR CORPORATION, U.S.A. MAKES NO OTHER WARRANTY OF ANY KIND, EXPRESSED OR IMPLIED. ALL IMPLIED WARRANTIES OF MERCHANTABILITY AND FITNESS FOR A PARTICULAR PURPOSE WHICH EXCEED THE OBLIGATIONS AND TIME LIMITS STATED IN THIS WARRANTY ARE HEREBY DISCLAIMED BY YAMAHA MOTOR CORPORATION, U.S.A. AND EXCLUDED FROM THIS WARRANTY.

SOME STATES DO NOT ALLOW LIMITATIONS ON HOW LONG AN IMPLIED WARRANTY LASTS, SO THE ABOVE LIMITATION MAY NOT APPLY TO YOU. ALSO EXCLUDED FROM THIS WARRANTY ARE ANY INCIDENTAL OR CONSEQUENTIAL DAMAGES INCLUDING LOSS OF USE. SOME STATES DO NOT ALLOW THE EXCLUSION OR LIMITATION OF INCIDENTAL OR CONSEQUENTIAL DAMAGES, SO THE ABOVE EXCLUSION MAY NOT APPLY TO YOU.

THIS WARRANTY GIVES YOU SPECIFIC LEGAL RIGHTS, AND YOU MAY ALSO HAVE OTHER RIGHTS WHICH VARY FROM STATE TO STATE.

YAMAHA MOTOR CORPORATION, U.S.A.
P. O. Box 6555
Cypress, California 90630

- Q. What costs are my responsibility during the warranty period?
- A. The customer's responsibility includes all costs of normal maintenance services, non-warranty repairs, accident and collision damages, and oil, oil filters, air filters, spark plugs, and brake shoes.
- Q. What are some examples of "abnormal" strain, neglect, or abuse?
- A. These terms are general and overlap each other in areas. Specific examples include: Running the machine out of oil, sustained high-rpm, full-throttle, operating the machine with a broken or damaged part which causes another part to fail, damage or failure due to improper or careless transportation and or tie down. If you have any specific questions on operation or maintenance, please contact your dealer for advice.
- Q. Does the warranty cover incidental costs such as towing or transportation due to a failure?
- A. No. The warranty is limited to repair of the machine itself.
- Q. May I perform any or all of the recommended maintenance shown in the Owner's Manual instead of having the dealer do them?
- A. Yes, if you are a qualified mechanic and follow the procedures specified in the Owner's and Service Manual. We do recommend, however, that items requiring special tools or equipment be done by a Yamaha Riva dealer.
- Q. Will the warranty be void or cancelled if I do not operate or maintain my new Riva exactly as specified in the Owner's Manual?
- A. No. The warranty on a new Riva cannot be "voided" or "cancelled." **However, if a particular failure is caused by operation or maintenance other than as shown in the Owner's Manual, that failure may not be covered under warranty.**
- Q. What responsibility does my dealer have under this warranty?
- A. Each Yamaha Riva dealer is expected to:
1. Completely set up every new machine before sale.
 2. Explain the operation, maintenance, and warranty requirements to your satisfaction at the time of sale, and upon your request at any later date.
 3. Each Yamaha Riva dealer is held responsible for his setup, service and warranty repair work.
- Q. Is the warranty transferable to second owners?
- A. Yes. The remainder of the existing warranty can be transferred upon request. The unit has to be inspected and re-registered by an authorized Yamaha Riva dealer for the policy to remain effective.

If your machine requires warranty service, you must take it to any authorized Yamaha Riva dealer within the continental United States. Be sure to bring your warranty registration card or other valid proof of the original date of purchase. If a question or problem arises regarding warranty, first contact the owner of the dealership. Since all warranty matters are handled at the dealer level, this person is in the best position to help you. If you are still not satisfied and require additional assistance, please write:

YAMAHA MOTOR CORPORATION U.S.A.
CUSTOMER RELATIONS DEPARTMENT
P.O. Box 6555
Cypress, California 90630

When contacting Yamaha Motor Corporation, U.S.A. don't forget to include any important information such as names, addresses, model, V.I.N (frame number), dates, and receipts.

CHANGE OF ADDRESS

The federal government requires each manufacturer of a motor vehicle to maintain a complete, up-to-date list of all first purchasers against the possibility of a safety-related defect and recall. This list is compiled from the purchase registrations sent to Yamaha Motor Corporation, U.S.A. by the selling dealer at the time of your purchase.

If you should move after you have purchased your new motorcycle, please advise us of your new address by sending a postcard listing your Riva model name, V.I.N (frame number), dealer number (or dealer's name) as it is shown on your warranty card, your name and new mailing address. Mail to:

YAMAHA MOTOR CORPORATION, U.S.A.
P.O. Box 6555
Cypress, California 90630
Attention: Warranty Department

This will ensure that Yamaha Motor Corporation, U.S.A. has an up-to-date registration record in accordance with federal law.

YAMAHA EXTENDED SERVICE (Y.E.S.)

Keep your Yamaha protected even after your warranty expires with genuine Yamaha Extended Service (Y.E.S.).

- Y.E.S. is designed and administered by Yamaha Motor Corporation to provide maximum owner satisfaction. You get uninterrupted factory-backed coverage for extra peace of mind.
- Y.E.S. is flexible. You choose the plan that's right for you: 12 months, 24 months, or 36 months beyond your warranty period.
- Y.E.S. is designed and administered by the same Yamaha people who handle your warranty — and it shows in the comprehensive coverage benefits. There are no mileage limitations. Coverage isn't limited to "moving parts" or the "drive train" like many other plans. And Y.E.S. covers manufacturing defects just like the warranty. See the sample contract at your Yamaha dealer to see how comforting uninterrupted factory-backed protection can be.
- You don't have to pay anything for covered repairs. There's no deductible to pay, and repairs aren't "pro-rated." You don't have any "out-of-pocket" expenses for covered repairs.
- In addition, Travel and Recreation Interruption Protection (TRIP) is included at no extra cost. TRIP gives you up to \$150 reimbursement per occurrence for any reasonable expenses you incur because your Yamaha needs covered service: replacement vehicle rental, emergency towing, phone calls, even food and lodging when you are away from home. This superb coverage goes into effect when you purchase Y.E.S., so it applies to any warranty repairs as well as covered repairs during your entire Y.E.S. plan period.
- Y.E.S. coverage is honored at any authorized Yamaha dealer nationwide.
- Y.E.S. coverage is transferrable to a new owner if you sell or trade-in. That can make your Yamaha much more valuable!

This excellent Y.E.S. plan coverage is only available to Yamaha owners like you, and only while your Yamaha is still within the Yamaha Limited Warranty period. So visit your authorized Yamaha dealer to get all the facts. He can show you how easy it is to protect your investment with Yamaha Extended Service.

We urge you to act now. You'll get the excellent benefits of TRIP coverage right away, and you'll rest easy knowing you'll have strong factory-backed protection even after your Yamaha Limited Warranty expires. You can also save money: Y.E.S. costs less within the first 90 days after you buy your Yamaha. See your dealer today!

A special note:

If visiting your dealer isn't convenient, contact Yamaha with your Primary ID number (your frame number). We'll be happy to help you get the Y.E.S. coverage you need.

Yamaha Service Marketing
P.O. Box 6555
Cypress, CA 90630



YAMAHA



EXTENDED



SERVICE

INDEX

A

- Acceleration and deceleration 5-2
- Adjusting the brake lever free play 6-21
- Adjusting the carburetor 6-19
- Adjusting the rear brake lever free play 6-21
- Adjusting the throttle cable free play 6-19
- Air filter and V-belt case air filter elements 6-8

B

- Battery 6-22
- Braking 5-3

C

- CONSUMER INFORMATION 9-1
- Care 7-1
- Carrier 3-8
- Cast wheels 6-21
- Catalytic converter 3-5
- Changing the brake fluid 6-13
- Checking and lubricating the cables 6-14
- Checking and lubricating the centerstand and sidestand 6-15
- Checking and lubricating the throttle grip and cable 6-14
- Checking the brake fluid level 6-13
- Checking the front brake pads and rear brake shoes 6-12
- Checking the front fork 6-15
- Checking the spark plug 6-7
- Checking the steering 6-16
- Controls and instruments 2-3

D

- DESCRIPTION 2-1

E

- Engine break-in 5-3
- Engine oil and oil strainer 6-24

F

- Final transmission oil 6-17
- Front brake lever 3-3
- Fuel 3-5
- Fuel gauge 3-3
- Fuel tank cap 3-4
- Further safe-riding points 1-5

G

- General maintenance and lubrication chart 6-3

H

- Handlebar switches 3-2
- Helmet holder 3-6

I

- INSTRUMENT AND CONTROL FUNCTIONS 3-1
- Identification numbers 9-1
- Ignition circuit cut-off system 3-9
- Indicator lights 3-2

K

- Kickstarter 3-6

L

- Left view 2-1
- Location of important labels 1-6
- Lubricating the front and rear brake levers 6-14
- Luggage hook 3-8

M

- Main switch/steering lock 3-1
- Motorcycle noise regulation 9-4

O

- OPERATION AND IMPORTANT RIDING POINTS 5-1
- Owner's tool kit 6-1

P

- PERIODIC MAINTENANCE 6-1
- PERIODIC MAINTENANCE AND MINOR REPAIR 6-1
- PRE-OPERATION CHECKS 4-1
- Parking 5-4
- Periodic maintenance chart for the emission control system 6-2
- Pre-operation check list 4-2

R

- Rear brake lever 3-4
- Removing and installing panels 6-6
- Replacing a turn signal light bulb 6-11
- Replacing the fuse 6-23
- Replacing the headlight bulb 6-16
- Replacing the tail/brake light bulb 6-11
- Reporting safety defects 9-3
- Right view 2-2

S

- SAFETY INFORMATION 1-1
- SCOOTER CARE AND STORAGE 7-1
- SPECIFICATIONS 8-1
- Seat 3-6
- Sidestand 3-8
- Speedometer unit 3-3
- Starting a cold engine 5-1
- Starting off 5-2
- Storage 7-3
- Storage compartment 3-7

T

- Tires 6-19
- Troubleshooting 6-26
- Troubleshooting chart 6-27

Y

YAMAHA EXTENDED SERVICE (Y.E.S.)	9-7
YAMAHA MOTOR CORPORATION, U.S.A STREET AND ENDURO MOTORCYCLE LIMITED WARRANTY	9-5

PROTECT YOUR INVESTMENT

Use *Genuine YAMAHA* Parts And Accessories

See your Authorized YAMAHA Dealer for a Genuine YAMAHA Service Manual.



PRINTED IN TAIWAN

2003.11-0.8 1 

(E)